

Hobie®

KAYAK AND ECLIPSE GEAR





CONTENTS

SECTIONS	PAGE
LIFE VESTS / PFD / SAFETY ACCESSORIES	2-4
SUNSHADE & DOGER	5
MIRAGEDRIVE® ACCESSORIES	6-7
MIRAGE SAIL	8-9
MIRAGE ISLAND	10-11
KAYAK CARTS	12-13
KAYAK DOLLIES / TRAILERS /	14-15
RACK PADS / STRAPS / LOAD ACCESSORIES	16-17
KAYAK & PEDALBOARD STORAGE	18-19
CARGO	20-23
H-RAIL	24-25
RAM MOUNTS	26-29
RAILBLAZA	30-31
SCOTTY	32-33
LIVEWELL	34-35
FISH FINDERS / MOUNTS / INSTALL KITS	36-39
DECK PAD KITS	40-41
ANCHORS / POWER-POLE	42-43
H-BAR / MAINTENANCE	44-45
ECLIPSE ACCESSORIES / SUP PADDLES	46-47
HOBIE EYEWEAR	48-49
MIRAGEDRIVE GT / V2	50-51
COMMON PARTS DIAGRAMS / SUPPORT	52-56
TOOLS / MISC ACCESSORIES	57



SCAN TO GO TO
HOBIE SUPPORT PAGES



SCAN TO GO TO
HOBIE PARTS LOOKUP

Note: Freight to dealers is not included in pricing.
No portion of this catalog may be reproduced without the express permission of the Hobie Cat Company.
All rights reserved. ©2022 Hobie Cat Company. Oceanside, CA 92056
Pricing subject to change. Printed in USA

SAFETY: LIFE VESTS / PFDS

HOBIE THIN-BACK by Stohlquist

Features a thin foam back design ... perfect for use with Hobie Vantage seats. This thinner back profile provides more mobility and comfort, while reducing interference with taller seat backs.

FEATURES: Thin back design works with all seat styles; Graded Sizing provides the best possible fit; Open sides for ventilation; Cross-chest cinch harness for zero ride-up; Mesh shoulders & interior panels for maximum ventilation; Adjustable shoulders, and dual forward pulls for a custom fit; Zippered front pockets offer organization; Built-in beverage holder and neoprene sunglasses sleeve; Entry grip tab at zipper base; #10 YKK zipper with non-corroding slider; Lightweight PE Foam; Type III PFD with sea level buoyancy: SM: 16 lbs, 8oz / LXL: 17 lbs / XXL: 17 lbs, 8oz

CONSTRUCTION:

- Mini Ripstop nylon outer shell
- 200 denier oxford liner
- USCG approved

SIZING: MEN'S

SIZE	CHEST
SM	30" - 40"
LXL	40" - 46"
XXL	46" - 52"

WOMEN'S

SIZE	CHEST
XSS	28" - 34"
ML	34" - 40"
PL	40" - 46"



Hobie Thin Back Men's Fish Slate Green

HOBIE EDGE by Stohlquist

An innovative, high mobility, low profile boating vest for kayaking, SUP, and wetsailing.

FEATURES: Ergonomic WRAPTURE™ shaped torso; Adjustable shoulders, 4 side pulls, and front waist buckle closure; Low cut, offset front-zip entry; Large arm openings for unrestricted whitewater and SUP paddling; Contoured padded shoulder straps; High visibility 3M™ reflective accents; Roomy, top loading front pocket for secure storage and easy accessibility; Mesh sides for maximum ventilation; Mini-Ripstop nylon shell & 200 denier oxford liner; Type III PFD with sea level buoyancy listed: SM: 15 lbs, 8oz / LXL: 16 lbs, 8oz / XXL: 17 lbs, 8oz

CONSTRUCTION:

- Mini Ripstop nylon outer shell
- 200 denier oxford liner
- USCG approved

SIZING: SIZE

SIZE	CHEST
SM	33" - 39"
LXL	40" - 46"
XXL	48" - 54"



Hobie Edge

+ SAFETY TIP

Get a good, comfortable life vest and WEAR IT! A life vest does you little good stored on your boat, especially if you get tossed into the water and away from your boat. Accidents happen and by their nature, they happen when you are not prepared. A life vest can keep you afloat until you can rescue yourself or you can be rescued by others. In the worst cases when injuries or cold water are involved, your life vest can make all the difference! Be sure everyone onboard your boat wears a life vest too! Pass the word! Federal law now requires that all persons below the age of 13 must wear a life jacket while aboard a boat.



GRADED PFD SIZING

Fine tuned for each individual size, and sculpted foam footprint and foam thickness to provide a better fitting, and more comfortable PFD for people of all sizes.

HOBIE INFLATABLE PFDS

Light weight and comfortable. Ready when you need it, manual CO2 inflation or by mouth inflator allows for swimming, wading and intentional immersion. **NOTE: AIR SHIPPING RESTRICTIONS CO2 / DANGEROUS GOODS**

FEATURES: Coast Guard Approved Type III Nearly twice the buoyancy of USCG foam PFD Shortened slim fit shell for improved comfort when pedaling a Mirage kayak. Mesh Yoke Back Strap for breathability and preventing ride-up Large Easy Access Storage pocket for increased storage capacity Inflates manually for flotation only when it's desired D-ring for accessory attachment Accessory attachment straps Interior pocket for holding spare CO2 inflation cylinder Fits 30-52" chests and users 16+ years Included 24g CO2 cylinder provides 26 lbs. of flotation.

HOBIE INFLATABLE BELT PACK PFDS

Belt carried PFD designs are cooler and more comfortable than typical PFDs. Functional design for multiple types of water sports from fishing, kayaking, sailing to stand up paddling (SUP). USCG Approved Type III PFD, approved for use by persons 80 lbs and 16 years of age or older. Size: Universal Adult Size. Durable ripstop nylon pack. 2" wide, adjustable, nylon waist belt. Includes (1) CO2 Cylinder and instructions. 16g offers Buoyancy 16.5 Pounds. Slim fit. **NOTE: AIR SHIPPING RESTRICTIONS CO2 / DANGEROUS GOODS**



Hobie Inflatable Belt Pack in Blue



Hobie Inflatable PFD in Green

HOBIE YOUTH/CHILD/INFANT VESTS

These are easy to adjust for different small sized crews.

50-90#
30-50#
<30#



Hobie Infant/Child/Youth Vests

S6103LXL PFD THINBACK MEN SUN L/XL
S6103SM PFD THINBACK MEN SUN S/M
S6103XXL PFD THINBACK MEN SUN XXL
S6104LXL PFD THINBACK MEN SLATE L/XL
S6104SM PFD THINBACK MEN SLATE S/M
S6104XXL PFD THINBACK MEN SLATE XXL
S6105ML PFD THINBACK WMN SUN M/L
S6105PL PFD THINBACK WMN SUN PLUS
S6105XSS PFD THINBACK WMN SUN XS/S
S6106ML PFD THINBACK WMN SLATE M/L
S6106PL PFD THINBACK WMN SLATE PLUS
S6106XSS PFD THINBACK WMN SLATE XS/S
S6107LXL PFD FISH THINBACK STGRN L/XL
S6107SM PFD FISH THINBACK STGRN S/M
S6107XXL PFD FISH THINBACK STGRN XXL

S6108LXL PFD EDGE BLKGRY L/XL
S6108SM PFD EDGE BLKGRY S/M
S6108XXL PFD EDGE BLKGRY XXL
S6771CLG PFD CHILD LIME GREEN 30-50#
S6771ILG PFD INFANT LIME GREEN <30#
S6771YLG PFD YOUTH LIME GREEN 50-90#
S6779R PFD INFLATABLE REARM KIT 24g
S6780R PFD INFLATABLE REARM KIT 16g
S6782BL PFD INFLATABLE BLUE - 24g
S6782GR PFD INFLATABLE GREEN - 24g
S6782RD PFD INFLATABLE RED - 24g
S6782TN PFD INFLATABLE TAN - 24g
S6783BL PFD BELT PACK INFLATABLE BLUE
S6783YL PFD BELT PACK INFLATABLE YELLO

SAFETY: LIGHTS, FLAGS & RESCUE



HOBIE SAFETY FLAG

New safety flag specially designed for Hobie kayaks. Be seen on the water! A triangle safety orange flag with reflective piping. The flag stands out from the pole without wind. Simple, easy to install and remove from the kayak and at a great low price! This new flag system uses the Hobie threaded fittings as the mount point. Simply remove one of the threaded fittings in the cargo area and install the specially designed flag holder fitting in it's place. The pole is held by a clamping thumb screw. When removing the flag, loosen the thumb screw and pull the pole out of the fitting. The threaded fitting remains in the kayak. The fitting also includes an eye to route the cargo bungee through.

RESCUE STEP

"How do I get back in if I fall out?" The RescueStep features quick and easy installation and operation for vessel re-entry assistance, righting an overturned kayak and can also be used to tow or portage your kayak. Its compact size makes it easy to bring along anywhere you need it.

HOBIE SAFETY KIT

This kit has many useful items for added safety when boating. Hobie Gear Bucket with Orange safety lid. Ready access is assured by hanging the safety kit on the inside lip of an 8" Hobie Twist and Seal hatch. Includes a 33 piece first aid kit, water proof flash light, signal mirror, space blanket, whistle, utility tool, waterproof matches, duct tape, gauze bandage, gauze pads, cloth tape (specific items subject to change).

HOBIE FIRST AID KIT

Waterproof 3600 Plano box with essential first aid items. Fits tackle management rack.

SAFETY WHISTLE

A whistle can save your life! Keep one attached to your PFD in case of overboard emergency. Alert approaching vessles. Alert other boaters or people ashore that you need help.

BILGE - HAND PUMP

This light weight bilge pump is extra security for long trips on the water. Features super-comfortable, easy-grip rubber over-molded handle and a high-visibility neon yellow stock for extra safety.



Hobie Safety Flag



Rescue Step



Hobie Safety Kit



Hobie First Aid Kit



Bilge - Hand Pump

1266 RESCUE STEP - BOAT

72020010 HOBIE SAFETY KIT

72020032 BILGE - HAND PUMP

72020078 HOBIE FIRST AID KIT

72020092 RESCUE STEP - KAYAK

72020108 SAFETY FLAG ASSEMBLY

MK0053 SAFETY WHISTLES

SUN SHADE & DODGER



HOBIE BIMINI

Relax all day under the cool shade of our all new kayak Bimini. UPF 50+ fabric and sophisticated articulation feature provide sun and rain protection no matter the time of day. Customize your setup, multiple color options including Sun Yellow and Marine Gray help create your unique look. The Hobie Bimini offers unprecedented comfort and sun relief to let you enjoy and extend your time on the water. Integrates with the Hobie accessory mount base for simple, no-drill installation to get you on the water in no time. The Aircraft grade aluminum mast provides a sturdy and stable base. Over-center, support beam adds extra rigidity and structure. A slight push retracts the beam, quickly collapsing for disassembly on the water should an unexpected squall pass through. Rear hooks easily fasten to pre-installed cargo padeyes and Bungees® for secure attachment and use on the water. **UPF 50+** fabric provides protection from the sun's powerful rays all day long, creating the space for longer and cooler days on the water. **Water-Resistant** Water-resistant coating guards against unexpected showers or ocean spray keeping you safe and dry from the elements. **Durable** The Hobie Bimini is designed to effectively withstand all of the action from your water adventures. The lightweight ripstop nylon is rugged and durable. *Note: Not for i-Series Inflatable kayaks.*

For more information and setup video: hobie.com/accessories/bimini



Hobie Dodger



Hobie Bimini

HOBIE DODGER

The Hobie Dodger is a spray, cool breeze and sun shade for your lower body. Deflect bow spray, block cool breezes and stay warmer in cold conditions.

Works like a small pop-up tent. Loops of bungee connect to the boat via small fittings installed along the rails. The entire dodger folds forward to enter or exit the kayak, to make pedal adjustments or reach items in the cockpit. An access panel is built-in for using the sailing rig. A great combination when there is wind and spray!

Great for hunters, animal and bird watchers as the Dodger conceals your legs movement. The Hobie Dodger makes your kayak a sit-inside sit-on-top!

Installs in minutes initially, but installs in moments once the fasteners are in place. Packs away into a small stow bag 5" round by 24" long (1.8 lbs).

Mirage Dodger Fits the Hobie Mirage Outback, Sport, Adventure and Revolution, Island kayaks (May fit other models with some modification to hardware placement). Includes an opening for a sail kit or Bimini mast. Island versions include a larger opening for the Island mast.

72020520 HOBIE BIMINI BLUE

72020521 HOBIE BIMINI GRAY

72020522 HOBIE BIMINI SUN YELLOW

72721001 KAYAK DODGER / SILVER

72722001 KAYAK DODGER / RED

72730002 DODGER - ISLAND / SILVER

72730004 DODGER - ISLAND / RED

MIRAGEDRIVE®

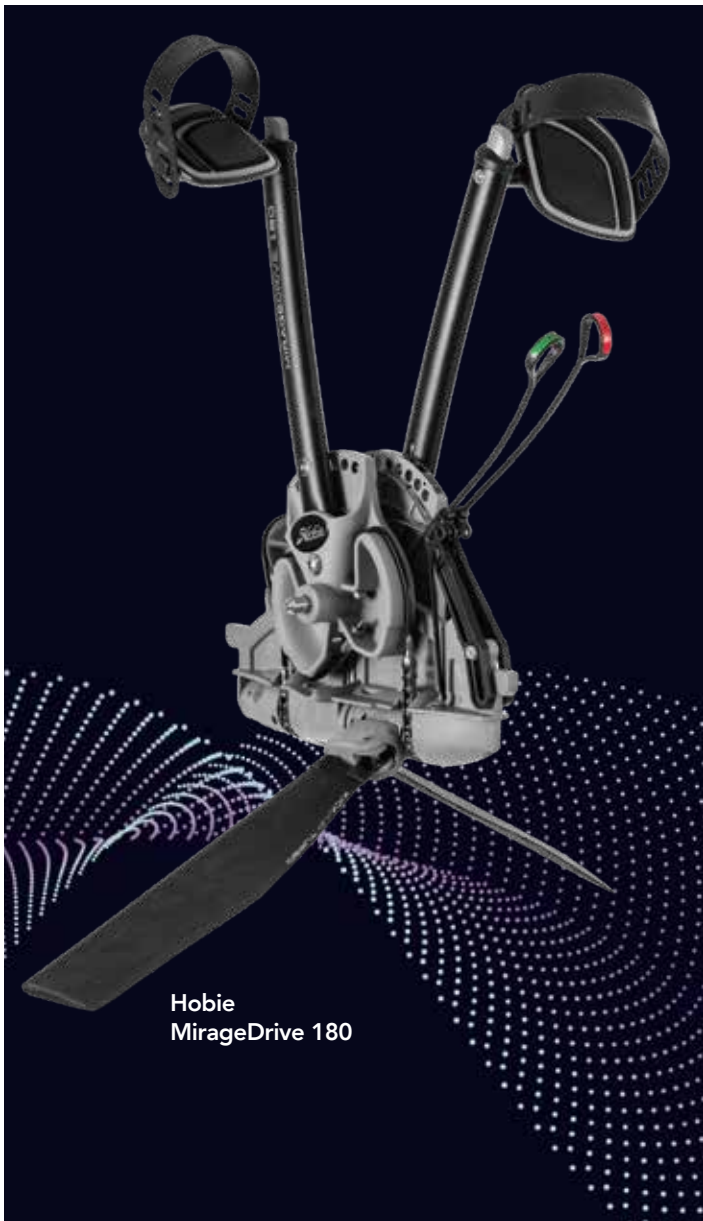

Hobie
MirageDrive 180

PERFORMANCE FINS - ST TURBO!

Increase your performance or increase your fitness routine, you choose the fin that is right for you: Standard or Turbo... low or a higher gear! This is very evident when using a sailing kit. The added power and speed of the sail often outpaces the standard fins (similar to pedaling a bike down hill in first gear).

Want to go really fast? Add TURBOs. Hobie Mirage kayak users report as much as 10% increase in speed and more using TURBO Fins. But its not all about speed, you can get top end speed and a slower cadence for cruising (Less pedals per mile). All achieved with these larger and more efficient fin designs. These longer fins can also increase lateral resistance for sailing upwind.



MD 180 ST Turbo Fin Kit



ST Turbo Red Fin Kit

MIRAGEDRIVE SPARE PARTS KITS GT & MD180

Spare parts kits include a fin, mast, sprocket (For GT Version), chain and appropriate parts for the drive version. Threaded sprockets and masts. All in a handy zippered pouch. Available for ST or ST Turbo fin drives.

LEASH KIT - MIRAGEDRIVE

Protect your investment from an accidental drop overboard. Includes hardware for attachment to the hull.

HOBIE MULTI-LUBE

A planet-safe lubricant recommended for lubricating MirageDrives and many other uses. Environmentally friendly for in-the-water applications. Hobie Multi-Lube offers excellent lubrication, is an anti corrosive coating, great for cleaning and many other uses... use on nearly anything that squeaks, rusts, corrodes or binds up; MirageDrives, rudder drums, cams, fishing reels and more. The 1 oz size is perfect for getting the lubricant into tight spaces by using the needle applicator. The 4 oz size has a spray applicator for coating chains and larger surfaces, shafts and bulky parts. Every Hobie owner should have Hobie Multi-Lube. Be nice to our planet, keep MirageDrives and other components running smoothly and lasting longer without polluting our waterways. Use it for all shop, home and sport lubrication needs.



Scan for Hobie
Support Pages



Scan for Hobie
Parts Look Up



MirageDrive Spare Parts Kits GT & MD 180



Leash Kit - MirageDrive

- 5120 HOBIE MULTI LUBE 1 OZ
- 5121 HOBIE MULTI LUBE 4 OZ
- 72065 ST-TURBO FIN KIT - GRAY/BLACK
- 72066001 ST-TURBO FIN KIT V2/GT - GRAY/
- 72066021 ST-TURBO FIN KIT V2/GT - RED/B
- 72066031 ST-TURBO FIN KIT V2/GT - BLU/B
- 72067002 ST-TURBO V2 FIN KIT MD180 BK/G

- 72067032 TURBO FIN KIT - KICK UP
- 74052101 LEASH KIT - MIRAGEDRIVE
- 80010401 MIRAGE GT SPARE PARTS KIT
- 80013401 MIRAGE GTT SPARE PARTS KIT
- 81527021 MD180 ST PARTS KIT
- 81527022 MD180 ST TURBO PARTS KIT

MIRAGE SAIL



MIRAGE KAYAK SAIL KIT

Add sail power to Hobie Mirage Kayaks! (Fits all current models of Hobie Mirage Kayaks). Sail with ease maintaining excellent speed with or without pedaling while sailing. Easily pedal out to sail or pedal home when the wind is too light. Add a SideKick ama kit for additional stability if desired. The MirageDrive pedal system's fins act as a keel or centerboard when in the down position offering the lateral resistance needed for upwind sailing.

SAIL KIT includes:
Mast*, sail (20.25 sq ft.), lines, fittings and storage bag.
(*2 Piece mast standard / 4 Piece mast for i-Series)

Add the large rudder #81397001 for more responsive rudder control. Adventure / Revolution 16 models can add the dagger board for enhanced upwind performance.



Mirage Drive Sail Kit Colors

ROLLER FURLING KIT

This is the ultimate for easy operation of a Hobie Mirage sail kit. Start with the sail rolled around the mast. When you are ready... un-furl to expose the sail or leave a little rolled on the mast to test the wind! By partially unrolling the sail, you are "reefing" some of the sail for better control and stability. If you are ready for full power... roll it all out! Heading back to the beach? Roll the sail up tight on the mast and beach or dock the kayak with ease. Fits any Hobie Mirage sail kit (not for i-Series kayaks due to their stayed rig). The rolled sail will fit in current full-length sail bags. Hardware is easy to install and removal of the sail and control lines is simple for storage.



Roller Furling Kit

AIR-FLOW TELL TAILS

Trim your sails for optimum performance. Attached air flow over sails is critical. Air flow directions are indicated by these tell tails. Made of light weight rip stop nylon (Red / Green). Attaches to sails with waterproof adhesive disks.

SAILING TIP

SAIL POWER: Watch the sail, pay close attention to the trim or adjustment of the sail. When the front of the sail, just behind the mast, luffs or flutters in the breeze, you lose power. To start moving, pull the sail in just enough to stop the sail from luffing or turn the boat away from the direction the wind is coming from. There are also short ribbons hanging on either side of the sail called "tell tails". The tell tails react to air flowing over the sail and will help you see that the sail is pulled in too tight or too loosely. If you pull the sail too tight you will stall the sail power. The tell tail on the back side of the sail will drop or do circles. Ease the sail out until it luffs, then pull it in just a little until it stops luffing. You will adjust the trim whenever the wind changes direction or you change course.

SIDEKICK AMA KIT

Great added stability for use when sailing, fishing, standing when sight fishing, diving or shooting photos! SideKick ama kit is simple, light weight and effective! Floats are inflatable.

The SideKick's cross arms adjust the float height with a simple "click-twist-click". Just like a paddle shaft adjustment. Three positions offer you high - medium - low positions. Set the floats high for cruising (less drag) or secondary stability. Use the medium or low settings for primary stability (less initial roll). Fine adjustments for float height are done by twisting the main crossbar within its mounts and tensioning with the fastening hardware. Set up and use right off the beach or disassemble and deflate to store inside the hull. Then assemble and inflate when you get to your dive or fishing spot. Inflation is simple. Just blow a few breaths into each float through their one-way valves. Valve cap unscrews for rapid deflation. Installs with 4 bolts using expanding nuts. Not for use on Pro Angler models.



SideKick Ama Kit



Sailing Gloves

334	AIR FLOW TELS, RED / GREEN	RF4850MD	GLOVES-FINGERLESS MD STICKY
72062061	SIDEKICK - ADP PLATES +07 ADV	RF4850SM	GLOVES-FINGERLESS SM STICKY
72062062	SIDEKICK - MOUNT KIT W/CTR BAR	RF4850XL	GLOVES-FINGERLESS XL STICKY
72062101	SIDEKICK AMA KIT - LT GRAY	RF4850XS	GLOVES-FINGERLESS XS STICKY
84512002	SAIL KIT KAYAK RED/SILVER	RF4851LG	GLOVES-3 FINGER LG STICKY
84513002	SAIL KIT KAYAK CHARTREUSE/SILV	RF4851MD	GLOVES-3 FINGER MD STICKY
84514002	SAIL KIT KAYAK PAPAYA/ORANGE	RF4851SM	GLOVES-3 FINGER SM STICKY
84515002	SAIL KIT KAYAK AQUA/CHARTREUSE	RF4851XL	GLOVES-3 FINGER XL STICKY
84516002	i - SAIL KIT KAYAK WHITE/PAPAY	RF4851XS	GLOVES-3 FINGER XS STICKY
84517001	FURLER KIT-KAYAK SAIL	79502001	DAGGERBOARD / ADV - REV 16
RF4850LG	GLOVES-FINGERLESS LG STICKY		

MIRAGE ISLAND



HOBIE ISLAND SPINNAKER/REACHER KIT

Add performance when reaching or running to your Hobie Island. Off-the-wind sailing is typically the slowest point of sail, add a spinnaker and the Island comes alive! The Hobie spinnaker kit includes a snuffer launching and retrieving bag which makes handling the spinnaker as easy as can be. Simply pull on the halyard line to launch, set the sheet and off you go! To lower, ease off the halyard and pull on the retrieval line. The spinnaker drops and stows directly into the snuffer system. The kit includes a mast head wind direction vane for use while rigged for the spinnaker. The mast head wind direction vane will help you keep the Island on course for spinnaker sailing. Spinnakers are for broad reaching across the wind to directly sailing down wind. They are not for sailing higher angles than a reach across the wind. *May require sail head modification by a sailmaker in older model Islands. Requires several inches of mast above sail head to fit into mast head fitting.

Note: Spinnaker sailing can be challenging and may not be for the novice sailor. We strongly suggest learning to sail your spinnaker in light winds. Once you learn how to handle a spinnaker... You are going to LOVE IT! Spinnakers add a whole new dimension to your sailing experience.



Spinnaker / Reacher Kit



Island Mast Head Wind Vane

HOBIE MIRAGE ISLAND TRAMPOLINES

Added space for carrying gear, allows you to move weight outboard for better performance in windy conditions, comfortable sitting or laying down position, carry additional crew / kids / pets (does not increase basic weight capacity), reduce spray in cockpit. The trampolines are made from mesh vinyl as used on our catamaran product. Available in Gray or Black. Easy installation. Fast (side-release) buckles across aft aka make folding akas quick. Adjustable webbing straps for a tight fit. Rolls down and straps to forward aka for storage or easily slips off the aka. Paddle storage, gear pockets and lanyard grommets included. (200 Lb Capacity)

ISLAND HIKING STICK

Extend your reach to your steering. Allows you to move your weight (hiking) outboard onto tramps or hakas for better stability, speed and comfort. Fits 2011+ Mirage model steering handles and all Tandem Islands.



Island Hiking Stick



Mirage Island Trampoline Extended



Mirage Island Trampoline Rolled Up



- 72020063 HIKING STICK - AI/TI
- 72020350 SPINNAKER KIT ADVENTURE ISLAND
- 72020351 SPINNAKER KIT TANDEM ISLAND
- 72020358 VANE REPLACEMENT-ISL SPINNAKER
- 79527001 TRAMP SET AI (- 2014) - BLACK
- 79527011 TRAMP SET AI (- 2014) - GRAY

- 79527201 TRAMP AI/TI - WEB/BUCKLE ASSY
- 88527001 TRAMP SET TI / 2015+ AI - BLAC
- 88527011 TRAMP SET TI / 2015+ AI - GRAY
- 88527201 TRAMP LEFT SIDE TI / 2015+ AI
- 88527301 TRAMP RIGHT SIDE TI / 2015+ AI
- 91050020 HOOK BLK NYLON SEW-ON

TRANSPORTATION: CARTS



Carts are a must for easily transporting your kayak to water’s edge. “Plug-in” carts do just that...they plug right into the bottom of your kayak. Choose Standard or Fold-and-Stow for lighter duty and solid surfaces, Heavy Duty for heavy loads and rough terrain or the “all-terrain” Hobie Trax 2 or Trax 2-30 which are the best over soft sand.

KAYAK CART “PLUG-IN” STANDARD

Light weight with durable 26 cm tires and strong spoked wheels. Stainless steel frame. Wheels are easily removable for storage. Also includes cart keeper feature and cart clamps. This cart has the medium capacity. (150 lb Capacity). Great for transport over solid surfaces.

**Note Tandem island use issue*

KAYAK CART “PLUG-IN” HEAVY DUTY

Highest capacity cart with very durable knobby (Solid Foam) 26 cm wheels. Welded Stainless steel frame. Wheels are easily removable for storage. Also includes cart keeper feature and cart clamps. This cart has the highest capacity. (225 lb Capacity) Suitable for Pro Angler and Tandem Island. Best for transport over solid surfaces.

**Note Tandem island use issue*

KAYAK CART “PLUG-IN” HOBIE TRAX “2”

The Trax “2” Cart has 24 cm (blow-molded polyurethane) pneumatic tires. These tires have a high capacity and are very durable! Welded Stainless steel frame. Wheels are easily removable for storage. (176 lb Capacity) This is an all around cart for soft sand and uneven terrain. The tires are wide and can be deflated for better performance over softer sand and soil. **Note Tandem island use issue*

KAYAK CART “PLUG-IN” HOBIE TRAX “2-30”

All of the great features of a Trax 2 cart with higher capacity! The Trax “2-30” cart has 30 cm tires, bringing the capacity up to 242 lbs. Even with a lighter load, the Trax 2-30 will be the best plug-in cart for sand.

**Note Tandem island use issue*



“Plug-In” Standard



“Plug-In” Heavy Duty



“Plug-In” Hobie Trax “2”



“Plug-In” Hobie Trax “2-30”

KAYAK CART “PLUG-IN” FOLD AND STOW

All new Plug-In Cart! Hobie Fold and Stow! Easily assemble for use or disassemble (<30 seconds) and stow on / in your boat. Disassembled parts fit inside most kayak hulls that have larger hatches. Stow bag included. New cart keeper feature is simple to use. Rotate the ball to the side to lock the cart in place. Pull on the cart to disengage and the ball pops back on top of the post. Aluminum frame (175 lb Capacity) No tools required.

**Note Tandem Island use issue. Plug in carts are not recommended for the Tandem Island due to weight. Using a plug in cart can damage the scuppers or deck area in the hull.*

KAYAK CART C-TUG

Carries up to 80kg (170lbs), dismantles for easy stowing, won’t rust. Requires no tools and assembles in seconds. Dismantles in seconds, allowing you to stow it in your kayak hatch. Made of non-corroding engineering polymers, with stainless steel reinforced axles, this cart is designed for harder terrains.

KAYAK CARTS FOR I-SERIES KAYAKS AND ECLIPSE

Plugs into the bottom of the Eclipse or inflatable series kayak’s MirageDrive well. Stainless steel frame. Wheels are easily removable for storage. Standard is Light weight with durable 26 cm tires and strong spoked wheels. This cart has the medium capacity. (150 lb Capacity). Great for transport over solid surfaces. Trax is designed for soft surfaces such as sand or pebbles. surfaces such as sand or pebbles.



“Plug-In” Fold and Stow



C-Tug



i/E Standard Cart

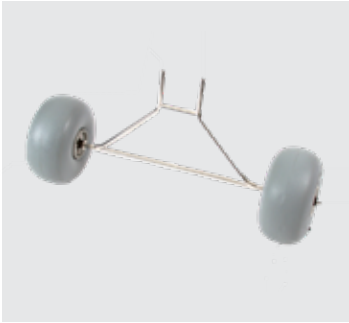

i/E Trax Cart (Pneumatic tires)



Fold and Stow Cart



CAUTION

Be certain that the cart inserts clear through the kayak and protrudes into the cockpit / cargo area surface. Kayaks should never be left on carts for prolonged periods of time.



80043001 HOBIE TRAX “2-30” CART PLUG-IN

80044101 HOBIE TRAX “2” CART PLUG-IN

80044202 CRADLE / PLUG-IN CART

80045001 HOBIE STANDARD PLUG-IN CART

80045101 i-SERIES / ECLIPSE PLUG-IN CAR

80045201 i-SERIES / ECLIPSE TRAX PLUG-I

80046001 HOBIE HEAVY DUTY PLUG-IN CART

80046021 PIN, QUICK CLIP KAYAK CART

80047001 HOBIE CART - FOLD AND STOW

80047201 CART C-TUG KAYAK CART

TRANSPORTATION: DOLLIES / TRAILERS



Full size dollies for the Adventure / Tandem Island or Pro Angler / Universal includes a hull / ama cradle, and a pull handle. Much stronger and easier to load and use than plug-in carts for larger, heavier models. Two different wheel styles allow for optimum performance on hard pack surfaces - or soft sand beaches. Choose beach wheels for use over soft sand or other surfaces. Choose the tuff tire if your launch surfaces are solid. The handle makes it easier to insert or remove the cart under the boat or pull along when un-loaded. The handle also acts as a "kick-stand" to keep the cradle upright during loading. The handle and wheels are easily removable for storage. The Pro Angler / Universal dolly will fit a wide variety of Hobie Kayaks including Pro Anglers, Outback and Oasis. Recommended maximum load equal to one Tandem Island without excess personal gear.



AI/TI Dolly Dolly
w/ 42 cm Beach Wheels



AI/TI Dolly Dolly
with Tuff Tires

LOADING



CAUTION

Cart and Dolly: Do not over-load. Not for towing or for speeds faster than average walking pace. Not for long hauls or stairs. Check cart fit carefully to be sure tires do not rub hull, on scupper versions that the posts fit clear through to the cockpit. Heavier model kayaks may require sleeves below cart clamps to keep hulls from contacting wheels. Not for prolonged use / storage. Incorrect use can damage or distort hulls.

KAYAK TRAILERS

Trailers ride on 8" wheels and use a 1 7/8" coupler. Trailex trailers are certified to USA DOT standards for use on USA roads. Carry one or more kayaks inverted on the crossbars (crossbar padding / cradles shown are not included with trailers). For the Adventure Island, Tandem Island or Pro Angler, add the custom designed hull cradle sets (Adventure Island V1 cradles shown to right on double trailer). These are form fitted and padding covered. For two Adventure Islands, order the double trailer (Double-Double for two Tandem Islands) add two cradle sets. The optional center Tower System adds storage possibilities. The Tower includes mast / sail hangers and is also designed to mount an equipment box on top. Easily mount the Hobie Toy Box on top of the Tower.

TRAILEX TRAILER - SINGLE AI / PRO A 12,14

Shown right. Order cradles separately.
(Crossbars 42" / 15' 2" assembled length / 220 lb Capacity).

TRAILEX TRAILER - SINGLE TI

Order cradles separately.
(52" Crossbars / 15' 6" assembled length / 350 lb Capacity).

TRAILEX TRAILER - DOUBLE

Shown above (Right) with AI and cradle set option and (#38652210) tower system. (84" Crossbars / 16' 1" assembled length / 550 lb Capacity). Order cradles separately.

TRAILEX TRAILER - DOUBLE / DOUBLE

Not shown. Required to carry 2 Tandem Islands or one TI and AI side-by-side.
(96" Crossbars / 16' 1" assembled length / 550 lb Capacity). Order cradles separately.

TOWER

Add the optional tower for equipment box mounting on a double trailer, multi kayak transport (Up to 4 kayaks leaned against tower). Also includes two mast carriers for 2x AI/TI configuration.



38652011 Single



*Trailer shown with Adventure Island cradles option

NOTE: Loads may require a red warning flag if over hanging lights by over 4 feet.

38652200 Double

Trailer prices DO NOT include freight to dealer or assembly costs.



CRADLES



72020406 AI V2 CRADLES 72020402 TI CRADLES 72020401 PRO A 12/14 CRADLES

* Refer to cradle instructions for proper spacing or 67" on all others

- 38652010 TRAILER HOBIE ALUM KAYAK SINGL
- 38652011 TRAILER HOBIE ALUM KAYAK TI SI
- 38652200 TRAILER HOBIE ALUM KAYAK DOUBL
- 38652201 TRAILER ALUM KAYAK DOUBLE DOUB
- 38652210 TOWER - TRAILER HOBIE ALUM DOU
- 72020401 CRADLE SET - PRO ANGLER TRAIL
- 72020402 CRADLE SET - TDM ISL TRAILER
- 72020406 CRADLE SET - ADV ISLD 2015+ TR

- 72020427 CRADLE SET - OUTBACK 2019+
- 72020428 CRADLE SET - COMPASS & DUO
- 72061001 PIN, LOCK SINGLE - KAYAK DOLLY
- 80046100 HOBIE DOLLY, AI/TI TUFF-TIRE
- 80046101 HOBIE DOLLY, PA-UNI TUFF-TIRE
- 80046200 HOBIE DOLLY, AI/TI BEACH-TIRE
- 80046201 HOBIE DOLLY, PA-UNI BEACH-TIRE

TRANSPORTATION: LOADERS / RACKS



HOBIE TIE DOWN STRAPS

Rack tie-down straps, made of durable black polypropylene webbing. Diagonal cut and ironed ends make threading ends into buckles easier.

HOBIE CAUTION FLAG

ROOF RACK PAD

Beefy car roof rack pads, made from durable black polyester with Hobie logo. Easy-on split bottom with Velcro™ closure.

QUICK STRAP SPORTRACK

Beefy car roof rack pads, made from durable black polyester with Hobie logo. Easy-on split bottom with Velcro™ closure.



Hobie Tie Down Straps



Hobie Caution Flag



Quick Strap Sportrack

COMPASS LOADER

Molded to fit snugly on the transom of the Hobie Mirage Compass and Compass DUO. The Compass loader is a load-assist tool. It incorporates rubber skids and handles to make car top loading of the kayak easier and helps prevent damage to the kayak during loading. **Scan QR code for video:**



RHINO LOADING ACCESSORIES

Load a kayak on to your vehicle without having to lift the full weight. Perfect for loading up solo or for car topping heavier boats.

UNIVERSAL SIDE LOADER

The Rhino-Rack Universal Side Loader assists you in loading your kayak, ladder, camping gear or other longer heavy items, onto your roof rack crossbars. Simply lift one end of your load onto the Rhino Universal Side Loader, then pivot your load onto your crossbars. Be sure to tie down your load once it is safely on the crossbars using load rated fastening straps.

FEATURES INCLUDE: Push button for quick release and easy storage; Crossbar clamps to suit all popular roof racks; Heavy duty storage bag; Support pole for loads greater than 44lbs (up to 132lbs); Integrated load stop prevents load from sliding off bar; foam padding for protection of your gear; Padding on the underside of clamps to protect vehicle roof; Fits all Rhino Aero, HD/Euro, all Thule Square, Aero bar & Wingbar, Rola, Prorack and Whispbar

T-LOAD HITCH MOUNT

The Rhino-Rack T-Load Mount is the perfect load carrying solution for long loads. Built tough from E coated Steel, the T-Load allows you to effortlessly load and transport your kayak. Mounting to a 2" hitch receiver the T-Load features an adjustable tilt position. A fitting kit is provided to attach your Rhino-Rack crossbars directly to the top of the T-Load and because we're top blokes we've also thrown in a non-slip mat to stop slippage when loading.

FEATURES INCLUDE: Single person use; Adjustable height & tilt position: Minimum height 950mm; Maximum height 1540mm; 1 x Rhino-Rack Aero crossbar; Rhino-Rack crossbar fitting; 1 x RTLK (Rhino-Rack T-Load Sling Kit); Non slip mat; 3 year warranty

NAUTIC KAYAK LIFTER

Is a complete system for easily loading and unloading sit on top kayaks. 80kg (176 lb) load capacity, does not require any heavy lifting and a single person can operate it using the included winch. The unit is designed to be neatly stored on the roof of your vehicle beside your kayak when not in operation.

Important Note: Designed to fit Rhino roof rack systems with bar overhang with at least 100mm. Contact Rhino for other rack Mfg compatibility.



Hobie Compass



Universal Side Loader



T-Load Hitch Mount



- 72035 QUICK STRAP SOFT RACK-24.0"
- 72040 QUICK STRAP RACK W/TIE DN
- 72044 PADS AERO BAR - 24"
- 72045 PADS ROOF RACK - 24"
- 72046 PADS ROOF RACK - 36"

- 72049 PADS AERO BAR - 36"
- 72042001 TIE DOWN STRAPS HOBIE- 12 FOOT
- 72043001 TIE DOWN STRAPS HOBIE- 15 FOOT
- MK0046 HOBIE CAUTION FLAG

- 777010 LOADER ASSY, 2019 OUTBACK
- 72040011 RHINO UNIVERSAL SIDE LOADER
- 72040012 RHINO NAUTIC KAYAK LIFTER

- 72040013 RHINO 2" RECEIVER T-LOADER
- 81711000 COMPASS LOADER

KAYAK & PEDALBOARD STORAGE



KAYAK COVERS

Easy to install or remove, fits over the hull (like a fitted sheet on a mattress). Straps and pull string adjust for a tighter fit. Cross straps secure the cover on your hull for windy conditions. Heavy duty UV resistant canvas material in a neutral color for better aging. Universal covers fit over the hull when upright or upside down. To help prevent distortions to the hull bottom shape, Hobie recommends that our kayak hulls be stored upside down resting on the cockpit rails. This is also best for deflecting rainwater and prevents water pooling in the cockpit or on the cover. When planning to store a hull upright, be sure to properly support the hull bottom to prevent hull distortions. Universal fit covers may not entirely cover some hulls, especially with accessories installed.

MIRAGEDRIVE STOW BAG

This heavy duty Cordura and mesh bag fits the complete MirageDrive with standard fins or the ST Turbo length. There is extra space in the bag for things like a life vest or drive well plug. Also includes "D" ring fittings to allow attachment to Inflatable rolling bags. Large enough to store your Inflatable's drive, pump and 4 piece paddle.

RUDDER COVER ISLAND / TI

Rudder protection for 2011+ AI and all Tandem Island Rudders.



MirageDrive Stow Bag



Custom PA 14 Cover



Rudder Cover

ECLIPSE BOARD BAG

These heavy duty padded travel bags fit the ECLIPSE 10.5 or 12.0. There is extra space in the bag for the handlebar assembly. Cart Access Slots allow you to use the plug-in Cart while the board is covered.

HOBIE ECLIPSE MIRAGEDRIVE STOW BAG

This heavy duty Cordura and mesh bag fits the complete MirageDrive with Flow Fins. There is extra space in the bag for things like a life vest or drive well plug.

HOBIE NOSE-RAIL PROTECTION KIT

Protect your Eclipse nose, rails and deck surfaces with EVA stick-on coverings. Kit includes sections to protect nose, rails and decks. Protects from scuffs and scratches.



Eclipse Board Bag



Eclipse MirageDrive Stow Bag

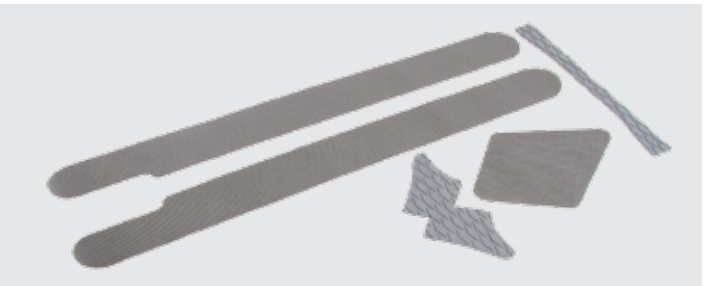

Hobie Nose-Rail Protection Kit

- 72050 KAYAK COVER / 9-12' 6"
- 72051 KAYAK COVER / 12-15'
- 72052 KAYAK COVER / 14-16'
- 72055 KAYAK COVER / PA 14 CUSTOM
- 72056 KAYAK COVER / PA 12 CUSTOM

- 72058 KAYAK COVER / AI CUSTOM 2015+
- 72059 KAYAK COVER / TI CUSTOM 2015+
- 72063 KAYAK COVER/OUTBACK CUSTOM
- 80024 BAG, MIRAGEDRIVE CARRY
- 82420001 COVER, RUDDER TI/2011+ AI

- 72050002 BOARD COVER - ECLIPSE 10.5
- 72050011 COVER - ECLIPSE DRIVE
- 72050013 ECLIPSE NOSE-RAIL GUARD KIT



CARGO ACCESSORIES & TACKLE MANAGEMENT

H-CRATE STORAGE SYSTEMS

- Fits on the back of a fishing kayak or SUP
- Keeps tackle, fishing rods and gear organized
- Lightweight & durable
- Can Be Disassembled to Store/Travel Flat

Weight: H-Crate 5.8 lbs / 2.63kg
Weight: H-Crate Jr. 5.05 lbs / 2.29kg
Includes: 4 Heavy duty straps
(Replacement 72020284)

H-CRATE SOFT COVERS

Vinyl cover with a zipper opening. Keeps gear drier and out of UV. Keeps gear in the crate from falling out in a capsize. Tested to extremes... the cover holds in place under heavy load even if inverted or tumbled. Easy to install using provided panel rivets. Double zipper is nylon, not corrosive and functions very smoothly.



H-Crate Soft Cover

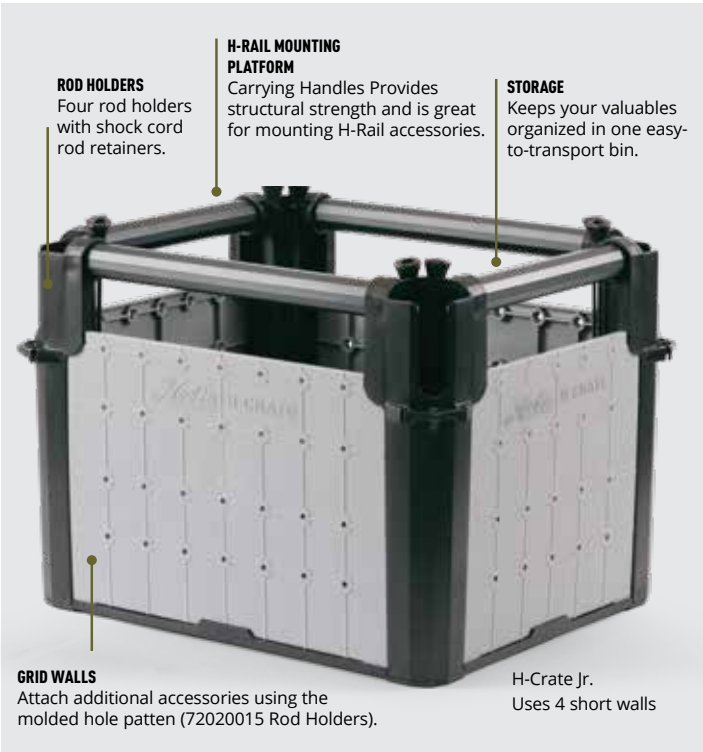

MOUNT ADDITIONAL ROD HOLDERS TO H-CRATE

You can mount many additional rod holders to the grid walls.
(Additional rod holders include the required fasteners)

PADEYE XL

Replace existing smaller padeyes to enable attachment of multiple straps or rod leashes on the same eye.



Padeye XL

HOBIE HATCH LINERS

For Hobie Mirage Outback, Revolution and Quest. The forward hatch liner is a space to store gear or fish just inside the forward hatch lid. Keeps items from sliding forward or back inside the hull and keeps them up off the bilge. Now available for the Hobie Outback, Revolution 11 / 13 and Quest 11 / 13 (2014+).

HOBIE GEAR BUCKET

Add a drop-in "tackle box" to your 8" Hobie Twist and Seal hatch. The Gear Bucket containers are 2 1/2" deep and hang on the hatch lip or can be slipped down into the hull so you can carry several. Keep one on the hatch lip for easy access. Easily size-adjustable storage segments. Get the three pack with handy storage bag and pre-pack your fishing tackle for fishing different species.

HOBIE GEAR BUCKET - DEEP

Add a drop-in "storage box" to your 8" Hobie Twist and Seal hatch. 5" deep bucket without dividers. *Note: Does not fit Pro Angler Aft Hatch*

PLANO TACKLE BOX

TACKLE BOX SMALL - 10 adjustable dividers create 5-15 compartments. Clear/Yellow 9.13" x 5" x 1.25"

TACKLE BOX MEDIUM - 15 adjustable dividers create 5-20 compartments. Clear/Blue 11" x 7.25" x 1.75"

TACKLE BOX LARGE - 25 dividers create 3-28 compartments. Perfect box for extra long bulk storage. Clear/Red 14" x 9.13" x 2"



Plano Tackle Box



Hobie Hatch Liners



Hobie Gear Bucket



- 71125 PAD EYE, SCREW-IN, XL
- 71704001 GEAR BUCKET
- 71704021 GEAR BUCKET - DEEP
- 71705001 GEAR BUCKET BAG
- 71706001 GEAR BUCKET 3 PAK W/BAG
- 72020015 ROD HOLDER - LIVEWELL/H-CRATE
- 72020041 HATCH LINER - OUTBACK <=2018
- 72020042 HATCH LINER - REVO 13 / 2013+
- 72020044 HATCH LINER - REVO 11/QUEST 11
- 72020088 HOBIE H-CRATE

- 72020097 H-CRATE SOFT COVER
- 72020109 HATCH LINER - OUTBACK 2019+
- 72020284 H-CRATE TIE DOWN STRAP ASSY
- 72020297 H-CRATE JR SOFT COVER
- 72020298 HOBIE H-CRATE JR
- 72020320 TACKLE BOX MD-BLUE
- 72020330 PLANO BOX, LG, RED
- 72020340 PLANO BOX, SM, YLW
- 84501201 HATCH LINER - PRO ANGLER 12
- 84501901 HATCH LINER - PRO ANGLER 14



CARGO ACCESSORIES & TACKLE MANAGEMENT CONTINUED

HOBIE TWIST AND SEAL HATCHES

Lids hinge open, so you never lose the lid. A simple twist of the handle opens or closes the hatch. The hatch does not have to be held down against a flat surface to seal. This allows the hatch to seal even if the lid is partially open or tipped. Available in 6" and 8" diameters. * Kits include gaskets and screws (8031131).

HOBIE RECTANGULAR TWIST AND SEAL HATCH KITS

Hobie's rectangular hatches are stiff and strong, and designed for standing on. Unique seal and flange lip drainage keep water out. Add the optional Tackle Management Rack to the horizontal kit, or add the Rectangular Gear Bucket to either the Horizontal or Vertical Hatch. Includes backing ring, hardware, gasket and instructions.

VANTAGE SEAT ACCESSORY BAG

The Vantage Seat Accessory Bag is the perfect addition to your MirageDrive® kayak. Ideal for storing extra tackle, keys and wallet, lunch, a foul weather jacket, birding glasses, safety gear and more.

Vantage Seat Accessory Bag Features:

- 4 easy Velcro straps for attachment to the Vantage seat back
- Water resistant construction for keeping things dry
- Key tether with YKK snap swivel for extra security
- Interior zipper pouch for organizing smaller items
- Drainage hole in the bottom of the bag to rid water and allow the interior of the bag to dry completely
- Clear visibility window in the top of the bag so you know exactly what you're reaching for
- Dimensions: approx. 8" Tall x 8" Wide x 3" Deep

GUSSETED STOW BAG

6" by 12" gusseted bag has hooks on both ends to clip to your boat. Also available in 8" x 15" size. Securely stow tools, gloves or small parts for easy access.



Hobie Twist and Seal Hatches



Hobie Rectangular Twist and Seal Hatch



Vantage Seat Accessory Bag

HOBIE RECTANGULAR HATCH ACCESSORIES

Add a drop-in "storage box" to your Hobie rectangular hatch or tackle management tray that deploys two tackle boxes as you open the hatch. Some hatch locations may not allow bucket use due to hull depth

HOOKLESS MAP POCKET

Molded material resists hooking. Replaces standard mesh pockets. Frame and fasteners included.

HOBIE SOFT COOLER/FISH BAG

Keep your food or catch cold all day, even in very hot conditions. High quality construction includes half-inch closed cell foam that insulates, vinyl coated polyester that's durable and YKK zippers that are strong. Has handles for carrying and d-rings on the sides for attaching to the kayak.

Large size Bag is approximately 70 qt. The top has an adjustable bungee cord for storing additional gear. Dimensions: 36 inches long, 8 inches tall, bag tapers from 10 inches wide in the front to 20 inches wide in the back. XL size Bag is approximately 120 qt. Dimensions: 48" long x 10" tall x tapered from 12" (top) to 30" wide (bottom) Medium size Bag is approximately 26 qt. Easy access zipper on top and drain plug on bottom. Fits inside front hatch of many Hobie kayaks. Dimensions: 24 inches long, 7 inches tall, bag tapers from 7 inches wide in the front to 16 inches wide in the back. Compass Bag is made specifically to fit the bow recess of the Mirage Compass.

PA BUCKET/ALL CARGO COOLER

Lids hinge open, so you never lose the lid. A simple twist of the handle opens or closes the hatch. The hatch does not have to be held down against a flat surface to seal. This allows the hatch to seal even if the lid is partially open or tipped. Available in 6" and 8" diameters. * Kits include gaskets and screws (8031131).

VIEW DRY BAG

Transparent 13 oz. vinyl bags make quick work of locating things. Its cylindrical shape will hold various shapes such as clothing, cameras, binoculars, lunches, etc. without distortion of bag and resultant potential leakage. Air purge vent.



Hobie Rectangular Bucket



Hobie Tackle Management



Hookless Map Pocket



Large Hobie Soft Cooler / Fish Bag



8031130 SCREW #10x 3/4 PHSM-PH SS(ABA

71321001 GASKET KAYAK HATCH 6"

71331001 GASKET KAYAK HATCH 8"

71701001 HATCH 6" TWIST-N-SEAL KIT

71701011 HATCH 6" TWIST-N-SEAL

71701021 O RING 6" TWIST-N-SEAL

71702001 HATCH 8" TWIST-N-SEAL KIT

71702021 O RING 8" TWIST-N-SEAL

71707003 RECTANGULAR HATCH KIT, HORIZON

71708001 TACKLE MANAGEMENT RACK KIT

71709002 BUCKET, HOBIE RECTANG HATCH V2

72020111 FISH BAG/COOLER LARGE

72020113 FISH BAG/COOLER MEDIUM

72020114 FISH BAG/COOLER COMPASS

72020117 VANTAGE SEAT ACCESSORY BAG

72020118 FISH BAG/COOLER XL

77701801 RECTANGULAR HATCH KIT, VERTICA

77800020 HATCH ASSY 8" V2

78561001 MAP POCKET MESH MOLDED HOOKLES

78565001 MAP POCKET MOLDED MESH W/FRAME

72005B POUCH SUPER GUSSETED 8x15

72210L VIEW DRY BAG VENTED 10L

72230L VIEW DRY BAG VENTED 30L



HOBBIE H-RAIL SYSTEM

ADJUSTABILITY IS ELEMENTARY.
Attaching, removing and adjusting H-Rail
accessories is literally as easy as one, two, three.

1. Wrap clamp around rail.

2. Latch gate and tighten.

3. Close locking lever.

H-RAIL RB STARPORT HD

Comes with the popular RAILBLAZA Starport HD with locking slide. Mounts to the 12-sided H-Rail without any drilling or tools needed.

H-RAIL RB MINIPOINT

The Hobie H-Rail MiniPort allows users to fit and re-task the full range of RAILBLAZA accessories to Hobie H-Rails. It clamps to the 12-sided H-Rail without any drilling or tools needed.

H-RAIL SCOTTY DECK/SIDE

We adapted this popular Scotty mount to fit our 12-sided H-Rail without any drilling or tools needed.

H-RAIL SCOTTY GEAR HEAD

H-Rail Gear-Head quickly slides into place and locks down your post mounted Scotty rod holders and accessories. This system allows you to quickly change rod holder positions with a simple "twist".

H-RAIL MINI TACKLE BIN

The H-Rail Mini Bin packs serious utility! It's slim and rugged design features a built-in 42" retractable gear tether, a tool holder for pliers or fish grips, four clip points for leashing down gear and raised drain channels in the floor so your gear won't ever sit in water. Four mounting locations for its integrated H-Rail clamp allows for a variety of orientations, giving you the flexibility to mount the bin just about anywhere you've got an open section of H-Rail. Perfect for holding the tools you need close to hand including your VHF radio, cell phone, packs of soft plastics or a digital camera for those fishing CPR tournaments. Overall dimensions: 9" L x 3" W x 4" T; bin dimensions: 5" L x 3" W x 4" T.



H-Rail RB Starport HD



H-Rail RB Miniport



H-Rail Scotty Deck/Side



H-Rail Scotty Gear Head



H-Rail Mini Tackle Bin



H-Rail Tackle Bin



H-Rail Cup Holder



H-Rail Mounting Plate



H-Rail G-Hold

H-RAIL TACKLE BIN

Add more storage or hold more gear. Designed to hold fishing tackle boxes, the tackle bin also includes a removable tray, Bungee® retainers, and plenty of places to clip things to. Store tools and use it as a place to collect odds and ends that usually clutter your fishing area.

H-RAIL CUP HOLDER

Always have your favorite beverage conveniently located and secure.

H-RAIL MOUNTING PLATE

Mount almost any accessory to the H-Rail using this universal mounting plate. It's durable, easy to drill through and flat on the top and bottom, allowing bolts, nuts and washers to fit snugly.

H-RAIL G-HOLD

Secure paddles, push poles, nets, gaffs or anything of moderate size up to 2 inches in diameter. The flexible quick-release strap has two securing points for security of minimum and maximum diameters, providing strong retention. It clamps to the 12-sided H-Rail without any drilling or tools needed.

H-RAIL MIGHTY MOUNT

Use it to attach your track mounted accessories. Use it as a standalone mount to secure your VISICarbon Pro™. Use it with the brand new Screwball™ or the Panfish™ camera pole.

H-RAIL RAM® MOUNTS

Add your favorite accessories to RAM Mounts on the H-Rail using the 1" or 1.5" ball.

H-RAIL ROD RACKS

Designed for horizontal rod storage. Padding on the interior protects your investment, plus rod retainers secure your rods in position for easy access, surf landings or transport. When rotated, the Rod Rack can be used for storing other accessories like a paddle, sail or stakeout pole.



H-Rail Rod Rack



H-Rail Rod Holder

H-RAIL ROD HOLDER

The H-Rail Rod Holder clamps to Hobie's H-Rail making it easily adjustable along the H-Rail or rotated to a desired angle inboard or outboard. A second lever allows the rod tube to be rotated at angles forward to aft. The rod holder can be clamped facing inboard or outboard depending on the desired use. It's a tube design with a removable gimbal pin and a reel holder that can be rotated to orient baitcasting or spinning rods into the perfect position. The two oversized padeyes can be used for rod leashes or to secure the rod holder to the boat and prevent it from slipping under high loads. Hobie always recommends using a rod leash and suggests the 72020099 Strap Kit to secure the rod holder in position for big game trolling.

DLX MOUNTING BOARD KIT - PRO ANGLER

2018 Pro Angler Deluxe Mounting Boards feature a built-in, center loading accessory track, knife holder, pliers holder and clip points for leashing gear. We've also given the topside a textured finish to increase friction with track mounted accessories. Installs simply and securely to pre-2018 model year Pro Anglers using included hardware.

HOBBIE HORIZONTAL ROD HOLDER KIT

Keep your fishing rod secure and protected along the side of your kayak. Insert the rod tip into the tip protector and lock the rod handle into the clasp. Easy to install using the provided hardware. Choose either through-bolts or sheet metal screws. Fits any kayak. Patent Pending.

ADJUSTABLE ROD HOLDER

Fits into Hobie's molded-in rod holders and fastens to the boat using 2 straps and padeyes (included). Release the lever to adjust the angle of the rod holder. Allows you to adjust the angle of their rod so it is best suited for the fishing situation. It is a tube design with a removable gimbal pin and a reel holder that can be rotated to orient baitcasting or spinning rods into the perfect position. The two oversized padeyes can be used for rod leashes. Extremely popular with anglers who like to troll. Hobie recommends using a rod leash to tether your rod to the kayak when fishing for big game.

HOBBIE ROD HOLDER EXTENSIONS

These fit right into the molded-in rod holders and offer a larger diameter sleeve that is deeper. Keep your fishing rods secure and reels higher out of the water. Leash the holder extension to the boat and the rod to the holder using the molded eyes.

HOBBIE ROD LEASH

Secure the rod leash to boat and rod. Quick snap connection feature allows easy detachment when needed. Webbing construction with quick connect hook.

HOBBIE GEAR KEEPER

Keep your equipment onboard with Hobie Gear Keepers. These low force retractor tools are ideal for gear such as pliers, dykes, lipper tools etc.

SMALL HOBBIE GEAR KEEPER: Features: 36" 50lbs Breaking Strength Spectra Nylon Line, Plastic Snap Clip, 3/8" Quick Connect Split Ring.

LARGE HOBBIE GEAR KEEPER: Features: 36" 60 lbs. Breaking Strength Nylon Coated Stainless Steel Cable, Stainless Steel Spring and Hardware, Plastic Snap Clip.

HOBBIE H-RAIL WITH INTEGRATED PATENTED RAM® HAND-TRACK™

Swap out the bungee in the rear H-Track DLX assembly with a second set of H-Rail + Integrated Track! This kit is a breeze to install, and increases no-drill mounting options behind the seat of any 2019 Outback.

H-Rail with integrated track yields a 17.5" multi-purpose mounting system for light AND heavy-duty applications. Clamp H-Rail rod holders to the rail for heavy-duty trolling, or use the track feature for lighter-duty accessory installations!

84622	MOUNTING PLT, RAIL MNT ASSY
72020000	HOBBIE GEAR KEEPER SMALL 36"
72020001	HOBBIE GEAR KEEPER LARGE 36"
72020014	ROD HOLDER EXTENSION
72020074	ROD HOLDER EXTENSION / ADJ
72020098	ROD HOLDER ASSEMBLY / H-RAIL
72020099	HD STRAP KIT
72020153	H-RAIL HAND-TRACK UPGRADE FOR OUTBACK
72021060	HORIZONTAL ROD HOLDER KIT
74052001	HOBBIE FISH ROD LEASH- WEBBING
84502121	DLX MOUNTING BRD KIT - PRO A
84620101	1" RAM BALL / H-RAIL
84620151	1-1/2" RAM BALL / H-RAIL
84620152	GEAR HEAD / H-RAIL
84620154	SCOTTY DECK-SIDE MOUNT / H-RAI
84620200	G-HOLD / H-RAIL
84620202	MINIPOINT / H-RAIL
84620204	STARPORT HD / H-RAIL
84621001	CUP HOLDER / H-RAIL
84623001	TACKLE BIN / H-RAIL
84623004	MINI BIN ASSY, H-RAIL
84624011	TRAY, H-RAIL TACKLE BIN
84625001	ROD RACK / H-RAIL (ONE)



RAM® MOUNTS

There are countless ways to customize your kayak using RAM® Mounts, making it the choice of kayak anglers and enthusiasts around the world. Secure action cameras, fish finders, phones, rod holders, transducers and more using your choice of ball and track bases. Explore the full line of RAM® kayak mounts below.

FISHING ROD HOLDERS & BASES

RAM® Mounts offers an extensive line of rod holders that are best suited to your kayak fishing needs. Whether you're using a spinning, bait casting or trolling rod, RAM® Mounts has you covered. Select a complete kit or mix and match to find your ideal rod holder and mounting base.

Compatible with RAM® Ball Adapter for GoPro®



72023073 RAM ROD® HD Rod Holder with 6" Spline Post
72023076 RAM ROD® Rod Holder with 6" Spline Post
72023077 RAM® Tube Jr.™ Rod Holder with 6" Spline Post

Compatible with RAM® Ball Adapter for GoPro®



72023074 RAM ROD® Jr. Rod Holder with 4" Spline Post
72023097 RAM® Adapt-A-Post™ Universal Flat Surface Drill-Down Base for Spline Posts

72023075 RAM® Adapt-A-Post™ with Adjustable 13.5" Extension Arm

72023089 RAM ROD® 8" Post Extension Arm

72023072 RAM® Tough-Tube™ Rod Holder with 3" Ratchet Spline Post Arm

72023072 RAM® Tough-Tube™ Rod Holder with 3" Ratchet Spline Post Arm



72023050 RAM ROD® Rod Holder with 1.5" C Size Revolution Socket Arm
72023049 RAM® Tube Jr.™ Rod Holder with 1.5" C Size Revolution Socket Arm
72023079 RAM ROD® Jr. Rod Holder with 1.5" C Size Revolution Socket Arm
72023048 RAM ROD® Fly Rod Holder with 1.5" C Size Single Socket Arm
72023051 RAM® Tube™ Rod Holder with 1.5" C Size Single Socket Arm

H-RAIL RAM® BALL ADAPTER

84620101 Hobie H-Rail Mount with 1" B Size RAM® Ball
84620151 Hobie H-Rail Mount with 1.5" C Size RAM® Ball

72023092 RAM® Adapt-A-Post™ Universal Post & Spline H-Rail Base



RAM® TRACK BALL™

Use this T-bolt ball adapter for most third-party tracks including Hobie H-Track and RAM® Tough-Track™.

72023058 1" B Size RAM® Track Ball™
72023059 1.5" C Size RAM® Track Ball™



RAM® TOUGH-TRACK™
& TRACK BASES

The RAM® Tough-Track™ takes innovation to the next level by offering a center access point for your track components and multiple track lengths to accommodate your desired mounting surface.



72023082
RAM® Tough-Track™
Top-Loading Composite
9" Track

72023081
RAM® Tough-Track™
Top-Loading Composite
5" Track

72023080
RAM® Tough-Track™
Top-Loading Composite
2.43" Track

72023096
RAM® Tough-Track™
Black Modular Aluminum
9" Track

72023095
RAM® Tough-Track™
Black Modular Aluminum
5" Track

72023094
RAM® Tough-Track™
Black Modular Aluminum
3" Track

72023098
RAM® Center Connector for
Black Modular Aluminum
RAM® Tough-Track™



72023086
RAM® Roller-Ball™ 2-Pack
Paddle & Accessory Holder



72023042
RAM® Bond-A-Base™ Adhesive Base
Shown with RAM® Tough-Track™ Top-Loading
Composite 5" Track



72023087
RAM® Vertical Tie Down
2-Pack Track Accessory



RAM® Adapt-A-Post™ Dual T-Bolt Universal
Track Base for Spline Posts



RAM® Adapt-A-Post™ Universal
2-Hole Drill-Down Base for Spline
Posts
Compatible with Post & Spline
systems for RAM® Mounts, Scotty,
Fish-On, Railblaza, Brocraft,
Cannon, Cabela's and Bass
Pro Shops

RAM® Adapt-A-Post™ Universal
Post & Spline Track base
Compatible with Post & Spline systems for
RAM® Mounts, Scotty, Fish-On, Railblaza,
Brocraft, Cannon, Cabela's and Bass
Pro Shops

ACTION CAMERA MOUNTS
WITH THE RAM® TOUGH-POLE™

Get the perfect shot when you're out on the water with the RAM® Tough-Pole™ for action cameras. Available in various lengths and kits with a wide range of mounting base options, the RAM® Tough-Pole™ is completely customizable to ensure the perfect fit for your setup.



72023070
1" B Size RAM® Ball
Adapter for GoPro®



72023034
1" B Size RAM® Action
Camera Ball Adapter

72023083
RAM® Tough-Pole™ 18" Single
Pipe Mount with RAM®
Track-Node™ Base

72023032
RAM® 18" PVC Pipe
Extension Pair with B Size
& C Size Socket Arms

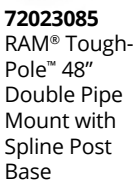

72023084
RAM® Tough-Pole™ 48"
Double Pipe Mount with
RAM® Track-Node™ Base



72023056
RAM® X-Grip® Phone Holder
with 1" B Size Medium
Composite Double Socket Arm



72023088
RAM® Twist-Lock™ Composite
Suction Cup Base with 1" B
Size Ball



72023035
RAM® Transducer
Mount with 18"
Aluminum Rod &
Socket Arm



72023016 1" B Size RAM® Wedge
Ball Adapter for Scotty and Hobie
Sail Port Base

72023015 1.5" C Size RAM®
Wedge Ball Adapter for Scotty and
Hobie Sail Port Base



72023065
1.5" C Size RAM® Tough-
Claw™ Small Clamping range
.625" to 1.5"



72023067
1.5" C Size RAM® Tough-
Claw™ Large Clamping range
1" to 1.875"



72023046
1.5" C Size RAM®
Composite Ball Base
2" x 2.25"



72023044
1" B Size RAM®
Composite
Diamond Ball Base

ACCESSORIES &
MORE BASES

Kayak fishing is all about adaptability. That's why RAM® Mounts offers a variety of accessories. These solutions are compatible with a wide range of RAM® mounting bases, allowing you to customize your kayak setup to best fit your needs.

RAM® MOUNTS ROD HOLDERS / BASES / ACCESSORIES

72023015	RAM MAST-TUBE WEDGE MOUNT 1.5"
72023016	RAM MAST-TUBE WEDGE MOUNT 1"
72023019	RAM DBL 1" BALL SOCKET ASSEMBL
72023020	RAM MOUNT TORQUEEDO THROTTLE
72023034	RAM GOPRO MOUNTING BASE 1"
72023035	RAM 18" TRANSDUCER MNT
72023040	RAM BALL 1" FLAT MOUNT
72023041	RAM BALL 1.5" FLAT MOUNT
72023042	RAM BOND A BASE - INFLAT/WHITE
72023044	RAM BASE 1" DIAMOND 2 7/16" X
72023046	RAM BASE 1.5" BALL 2" X 2.5"
72023047	RAM DBL BALL SOCKET ARM 1.5" P
72023048	RAM ROD 2007 JR. FLY ROD HOLDE
72023049	RAM TUBE JR HOLDER
72023050	RAM ROD 2000 ROD HOLDER
72023051	RAM TUBE 2008 ROD HOLDER
72023052	RAM FISH FINDER BASE W/ 1" ARM
72023054	RAM LOWRANCE BASE W/ 1.5" ARM
72023055	RAM LOWRANCE BASE W/ 1.5" ARM
72023056	RAM X-GRIP UNIVERSAL HOLDER W/
72023057	MOUNT, i-SERIES FISHFINDER
72023058	RAM 1" TRACK BALL
72023059	RAM 1.5" TRACK BALL
72023060	RAM MOUNT 1" BALL & ARM HOOK2
72023061	RAM MOUNT 1.5" BALL & ARM HOOK
72023065	RAM SM TOUGH CLAW w/1.5" BALL
72023067	RAM LG TOUGH CLAW w/1.5" BALL
72023070	RAM BALL 1" FOR GOPRO BASE
72023071	RAM SPLINE POST BASE
72023072	RAM TOUGH TUBE W/ 3" SPLINE PO
72023073	RAM ROD HD HOLDER W/ 6" SPLINE
72023074	RAM ROD JR HOLDER W/ 4" SPLINE
72023075	RAM ADAPT-A-POST EXTENSION 13.
72023076	RAM ROD HOLDER W/ 6" SPLINE PO
72023077	RAM TUBE JR HOLDER W/ 6" SPLIN
72023079	RAM ROD JR HOLDER W/ 1.5" SOCK
72023080	RAM TOUGH TRACK 2.43" COMPOSIT
72023081	RAM TOUGH TRACK 5" COMPOSITE
72023082	RAM TOUGH TRACK 9" COMPOSITE
72023083	RAM TOUGH-POLE 18" W/ Track No
72023084	RAM TOUGH-POLE 48" W/ SPLINE P
72023085	RAM TOUGH-POLE 36" W/SPLINE PO
72023086	RAM ROLLER-BALL ACC HOLDER - 2
72023087	RAM TRACK TIE DOWN/PADEYE - 2
72023088	RAM SUCTION BASE W/ 1" BALL
72023089	RAM ROD 8" POST EXTENSION ARM
72023090	RAM ADAPT-A-POST T-BOLT MOUNT
72023091	RAM ADAPT-A-POST 2 T-BOLT TRAC
72023092	RAM ADAPT-A-POST H-RAIL MOUNT
72023093	RAM ADAPT-A-POST 2 HOLE MOUNT
72023094	RAM TOUGH-TRACK 3" ALUMINUM
72023095	RAM TOUGH-TRACK 5" ALUMINUM
72023096	RAM TOUGH-TRACK 9" ALUMINUM
72023097	RAM ADAPT-A-POST 4 HOLE MOUNT
72023098	RAM TOUGH-TRACK CONNECTOR

RAILBLAZA



Diverse, flexible and user-friendly mounting systems and accessories. Your StarPort™ can be mounted just about anywhere! Then add the desired accessories to mount onto the starport

STARPORT

The StarPort allows users to fit and re-task the full range of RAILBLAZA accessories. The StarPort can be used as either a deck mount or flush mount base. This base not only comes with a gasket and cap, but also features a slide locking mechanism to confidently lock the RAILBLAZA accessory in place. Stainless Steel mounting hardware included.



H-RAIL READY!

H-RAIL STARPORT HD

Mount the Hobie H-Rail StarPort HD on the 12-sided H-Rail without any drilling or tools needed.



FIXED EXTENDER

The Fixed Extender gives you 5 inches of clearance from the StarPort – an optimum distance for freeing up the cockpit and creating additional leg room on kayaks.



H-RAIL MINIPOINT

Mount the Hobie H-Rail MiniPort on the 12-sided H-Rail without any drilling or tools needed.



AKA STARPORT MOUNT

AKA StarPort Mounts allow the easy attachment of a RAILBLAZA StarPort to your Hobie AKA (V2). The StarPort Mount is designed to fit securely on the AKA of an Island or Tandem Island without twisting.

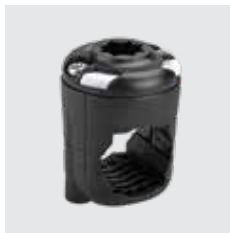

H-RAIL G-HOLD

Secure paddles, push poles, nets, gaffs or anything of moderate size up to 2 inches in diameter. The flexible quick-release strap has two securing points for security of minimum and maximum diameters, providing strong retention. It clamps to the 12-sided H-Rail without any drilling or tools needed.

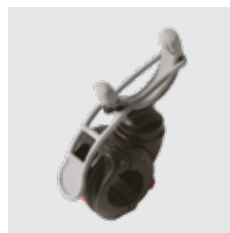

ROD HOLDER II

Hold a bait caster, spinning rod, trolling rod, or fly rod. The rotating collar secures rod in place and the rear gimbal lock reduces rod rotation for compatible rods. Also offered with the StarPort HD mount (Stainless Steel mounting hardware included with 72026209 Rod Holder II / StarPort HD).



TECH TIP

FOR ALL ITEMS WITH POLYCARBONATE LOCKING SLIDE- IMPORTANT: Use of petroleum-based lubricants on the StarPort slide will cause failure. Silicone-based lubrication products are required.

VISIBILITY KIT II

The RAILBLAZA Visibility Kit II is a must-have safety item for any kayak angler or recreational paddler. The Visibility Kit II meets US Coast Guard 2 Nautical Mile regulations, and disassembles when you're finished to be stored just about anywhere. The i360 light portion can be fitted to any RAILBLAZA StarPort around the kayak. The Extenda Pole 1000 portion can be used to display a flag, or combine with RAILBLAZA camera mounts as a camera pole.

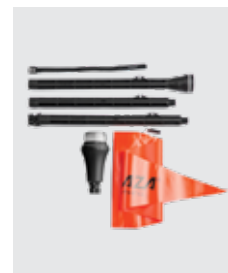

G-HOLD 50

The G-Hold 50 is recommended to secure paddles, boga grips and anything of moderate size up to 2 inches around. The flexible quick-release strap has two securing points for security of minimum and maximum diameters, providing strong retention. G-Holds install in any RAILBLAZA base.



CAMERA BOOM 600

The Camera Boom 600 is the perfect way to hold the camera and capture the action. Capturing your adventure from the perfect angle is now made easy. Over 30 inches long and fully adjustable with 4 moving joints, capturing any angle is possible. This camera mount will fit into any RAILBLAZA StarPort.

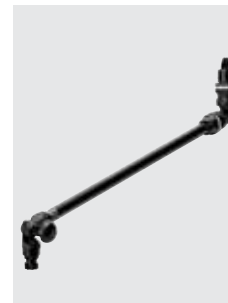

CAMERA MOUNT KIT

With the RAILBLAZA Camera Mount Kit, you can securely mount your camera on your kayak, paddleboard, or many other surfaces by simply making it StarPort compatible. The kit is compatible with any camera featuring a 1/4-20 thread insert while also including a GoPro tripod adaptor to make the kit compatible with all GoPro cameras.



ROTATING PLATFORM

The Rotating Platform allows for 360 degrees of rotation, easily clips in and out of your StarPort. Perfect for mounting fish finders, cameras, or other electronics.



I-SERIES BASE - RIBPORT

Expand the rigging capabilities of inflatables, stand up paddleboards or coolers (without drilling). The i-Series Base allows the addition of useful StarPort attachments. The 6x4-1/2 inch base is easily applied to any flat surface with the included 3M backing adhesive.



RAILBLAZA ROD HOLDERS / MOUNTS:

- 72026200 RB ROD HOLDER II ONLY BLACK
- 72026201 RB ROTATING PLATFORM 102MM(4")
- 72026202 RB G-HOLD 50MM(2") SINGLE BLK
- 72026203 RB GUNHOLD (1)
- 72026204 RB CAMERABOOM 600 PRO SERIES
- 72026205 RB CAMERA MOUNT KIT
- 72026206 RB BLACK RIBPORT / STARPORT W/
- 72026207 RB STARPORT BLACK
- 72026209 RB ROD HOLDER II STARPORT HD K
- 72026210 RB RAILMNT AKA STARPORT COMB B
- 72026211 RB 5" FIXED EXTENDER
- 72026214 RB VISIBILITY KIT II



Innovative designs and many versatile mounting options, we're sure you'll find the exact combination you're looking for. Scotty Rod holders were designed with one major purpose in mind: Fight the fish, not the fishing gear!

ROCKET LAUNCHER

Fully Adjustable rod holder, composite construction, accommodating all rods. Mount not included.



RODMASTER II

Fibre reinforced engineering nylon offers strength, resilience and reliability. Also comes with a removable gimbal pin. Mount not included.



BAIT CASTER

Holds a bait caster reel in a cushioned cradle. A slot in the front of the rod holder allows for a spinning reel to be securely held in position. The rod holder design has a side mounted flange, which leaves the bottom open. This allows for the rod holder to accommodate trigger grips. Pistol grip rod butts easily clear the sides of the rod holder for quick rod retrieval. Rod can be secured in holder with a soft latching strap which snaps over the top. Mount not included.



FLY ROD HOLDER

Allows hands free trolling with a fly rod. Fully adjustable and includes a safety strap. Fly Rod Holder Interior Diameter: 1.16" Mount not included.



FLUSH MOUNT

Sealed base for watertight applications (such as kayak decks). For all Scotty post mount rod holders. Dimensions: 4" x 2" x 2", Bolting Dimensions: 1 5/16" x 3 3/16"



DECK / SIDE MOUNT

1.16", Mount Dimensions: 4" x 2" x 2", Bolting Dimensions: 1 5/16" x 3 3/16"



H-RAIL SCOTTY DECK/SIDE

We adapted this popular Scotty mount to fit our 12-sided H-Rail without any drilling or tools needed.



H-RAIL GEAR HEAD

H-Rail Gear-Head quickly slides into place and locks down your post mounted Scotty rod holders and accessories. This system allows you to quickly change rod holder positions with a simple "twist".



SCOTTY ROD HOLDERS / MOUNTS:

- 80048006 GEAR HEAD MOUNT
- 80048011 ROD HOLDER - BAIT CASTER ONLY
- 80048014 ROD HOLDER - RODMASTER II ONLY
- 80048015 ROD HOLDER - ROCKET LAUNCHER O
- 80049011 FLUSH DECK MOUNT W/HARDWARE
- 80052011 DECK / SIDE MOUNT W/HARDWARE
- 80055011 ROD HOLDER - FLY ONLY

LIVEWELL



HOBIE LIVEWELL V2

The newly redesigned Hobie Livewell sports a fresh color scheme, modern lines and more built-in features than ever before. This livewell is plug-and-play with most Hobie kayaks and includes: (1) 6V sealed gel cell battery + charger for powering the pump, an adjustable downspout for filling the tank half way, a corrosion resistant power switch, 3 integrated rod holders, a threaded drain plug, easily removable tank partitions for keeping bait healthy, an 8" Twist and Seal hatch for access and bait concealment, heavy-duty straps for attaching it to the kayak and a carrying handle for easy transport.

FEATURES: High output pump circulates aerated water to keep bait alive, Battery and Charger included, Sealed Marine Switch for ON/OFF control, Adjustable downspout for water level control and drainage, Holds up to 8 gallons of water, Removable tank partition provides a rounded surface for keeping bait healthy, 3 vertical rod holders included, with pre-marked locations for adding more, 8" Twist and Seal lid for tank access & bait concealment, Carrying handle for easy transport, Heavy Duty straps secure livewell to cargo area, Pump cap for filling the tank with non-circulating water, Threaded drain plug keeps tank interior dry between uses.



Hobie LiveWell V2



HOBIE LIVEWELL XL

Larger capacity, fits all Pro Angler models. 6 gal/22.71 L and 11 gal/41.64 L. The Hobie Livewell XL Bait Tank is a new, larger version of the original Livewell. It comes with a tank partition that keeps debris and critters from clogging the internal pumps and drains. Custom designed with the serious angler in mind, simply charge the included battery and you're ready to go.

The removable tank partition keeps debris and critters from clogging internal pumps and drains or hiding in hard to reach areas. The partition also provides a rounded surface so baitfish stay healthy and happy.



Hobie LiveWell XL



72020077 HOBIE LIVEWELL V2

72020072 HOBIE LIVEWELL XL

FISH FINDERS, MOUNTS & BATTERIES



FISHFINDER HOOK2 4X GPS

Great for kayaks, the compact HOOK² 4x GPS features proven Broadband Sounder™ and a basic GPS plotter. If basic navigation is all you need, the simple and accurate GPS plotter of the HOOK² 'x' models let you add waypoints, follow trails and navigate to your favorite fishing spots. (*'x' models do not support add-on mapping such as C-Map).
Compatible FF Mount 72023060 RAM 1" paired with equal size RAM ball of choice.

HOOK REVEAL 5 SPLITSHOT

Hook Reveal 5 SplitShot features High CHIRP sonar and DownScan Imaging™ with FishReveal™, plus single frequency broadband sonar. This all-new unit also features pre-loaded C-Map US Inland mapping and Genesis Live, allowing you to map uncharted water in real-time. A microSD card slot accepts a C-Map Insight Pro card (pn 72020221), giving you coverage of the entire US Inland and Coastal waters on a single SD card without any download required. SolarMAX™ Display, new color palettes and one-touch access to key features makes for a high-end experience at an affordable price. *Compatible mount: 72023061 RAM MOUNT 1.5" HOOK or 72023060 RAM Mount 1" Hook paired with equal size RAM ball of choice.*

HOOK REVEAL 7 SPLITSHOT

Hook Reveal 7 SplitShot features all the same capabilities as the smaller Hook Reveal 5 SplitShot, just with a larger screen and better target separation. High CHIRP sonar and DownScan Imaging™ with FishReveal™, plus single frequency broadband sonar makes finding fish easier than ever. This all-new unit also features pre-loaded C-Map US Inland mapping and Genesis Live, allowing you to map uncharted water in real-time. A microSD card slot accepts a C-Map Insight Pro card (pn 72020221), giving you coverage of the entire US Inland and Coastal waters on a single SD card without any download required. SolarMAX™ Display, new color palettes and one-touch access to key features makes for a high-end experience at an affordable price. *Compatible mount: 72023055 RAM MOUNT 1.5" paired with 1.5" RAM ball of choice.*

- 1 - CHOOSE A FISHFINDER...
- 2 - CHOOSE A MOUNT...CHOOSE A BASE...
- 3 - CHOOSE AN INSTALLATION KIT



Hook Reveal 9 TripleShot



Elite 9 FS

HOOK REVEAL 7 TRIPLESHOT

Hook Reveal 7 TripleShot features High CHIRP sonar, SideScan and DownScan Imaging™ with FishReveal™, plus single frequency broadband sonar, allowing you to identify structure and fish in every direction! This all-new unit also features pre-loaded C-Map US Inland mapping and Genesis Live, allowing you to map uncharted water in real-time. A microSD card slot accepts a C-Map Insight Pro card (pn 72020221), giving you coverage of the entire US Inland and Coastal waters on a single SD card without any download required. SolarMAX™ Display, new color palettes and one-touch access to key features makes for a high-end experience at an affordable price. *Compatible mount: 72023055 RAM MOUNT 1.5" paired with 1.5" RAM ball of choice.*

HOOK REVEAL 9 TRIPLESHOT

Hook Reveal 9 TripleShot features the largest screen and best target separation in our line of Hook Reveal offerings. High CHIRP sonar, SideScan and DownScan Imaging™ with FishReveal™, plus single frequency broadband sonar allows you to identify structure and fish in every direction! This all-new unit also features pre-loaded C-Map US Inland mapping and Genesis Live, allowing you to map uncharted water in real-time. A microSD card slot accepts a C-Map Insight Pro card (pn 72020221), giving you coverage of the entire US Inland and Coastal waters on a single SD card without any download required. SolarMAX™ Display, new color palettes and one-touch access to key features makes for a high-end experience at an affordable price. *Compatible mount: 72023055 RAM MOUNT 1.5" paired with 1.5" RAM ball of choice.*

ELITE 7 FS

The Elite Fishing System (FS) combines the power of Lowrance's proven and newest fishfinding tools with a more affordable display that's easier to use. ActiveTarget™ Live Sonar compatible. Active Imaging 3-in-1 transducer included. FishReveal™. Preloaded C-Map® Contour+ inland and coastal charts with 1-foot contours on 15,000+ US lakes and 9,400+ Canadian lakes. C-Mapp Genesis Live onscreen mapping. High-resolution multi-touch touchscreen. Integrated wireless, NMEA 2000® and Ethernet connectivity. Full touchscreen control of Power Pole® anchor. *Compatible mount: 72023055 RAM MOUNT 1.5" paired with 1.5" RAM ball of choice.*

ELITE 9 FS

The Elite Fishing System (FS) combines the power of Lowrance's proven and newest fishfinding tools with a more affordable display that's easier to use. ActiveTarget™ Live Sonar compatible. Active Imaging 3-in-1 transducer included. FishReveal™. Preloaded C-Map® Contour+ inland and coastal charts with 1-foot contours on 15,000+ US lakes and 9,400+ Canadian lakes. C-Mapp Genesis Live onscreen mapping. High-resolution multi-touch touchscreen. Integrated wireless, NMEA 2000® and Ethernet connectivity. Full touchscreen control of Power Pole® anchor. *Compatible mount: 72023055 RAM MOUNT 1.5" paired with 1.5" RAM ball of choice.*

C-MAP INSIGHT PRO

Coverage of the entire US Inland and Coastal on a single SD card without any download required.

POINT-1 GPS ANTENNA

The ideal position and heading device. The Point-1 provides extremely accurate and rapid boat position and speed updates.

NMEA2000 STARTER KIT

Warranty on Lowrance product is handled by Lowrance:
<https://www.lowrance.com/help-and-support/warranty-information/>

- 72020070 FISHFINDER POWER KIT
- 72020127 NMEA2000 STARTER KIT
- 72020143 FISHFINDER ISERIES INSTALL KIT
- 72020144 FISHFINDER RUDDER INSTALL KIT
- 72020145 FISHFINDER LITHIUM POWER KIT
- 72020208 FISHFINDER HOOK2 4x GPS
- 72020223 ELITE FS 7 AI 3-IN-1 US/CAN
- 72020224 ELITE FS 9 AI 3-IN-1 US/CAN

2 - FISHFINDER MOUNTS BY RAM



Ram Fish Finder Base w/ 1" Arm



Ram Lowrance Base w/ 1.5" Arm



Ram Lowrance Base w/ 1" or 1.5" Arm



Ram Lowrance Base w/ 1.5" Arm

...THEN CHOOSE RAM BASE (PAGE 28-29)

3 - FISHFINDER INSTALLATION KITS

FISHFINDER POWER KITS FOR LOWRANCE READY/GUARDIAN

These kits include everything you need for wiring up your fishfinder to any Hobie kayak with the "Lowrance Ready" feature. Kit Includes: 12V 9AH waterproof gel cell battery and charger or NOCQUA Lithium battery system, wiring hardware, and battery holder which mounts to the sail / accessory post or in the lip of an 8" twist and seal hatch. (For Passport 12 requires 72026217 Fit Kit).

FISHFINDER I-SERIES INSTALLATION KIT

Hobie's plug-and-play option for outfitting your inflatable kayak with a fish finder. This kit includes everything you need to install and power a fish finder on your Hobie iSeries kayak. We've incorporated our Rudder Ready* transducer mounting kit, a custom RAM fishfinder mount extension that attaches to your Vantage seat, a lightweight PRO POWER 12V, 10 amp hour lithium battery, charger and wiring components. Simplifies transducer mounting on inflatable kayaks with wires run externally.
*Not suitable for retractable Pro Angler style rudders.

FISHFINDER RUDDER READY INSTALLATION KIT

Hobie's Rudder Ready fish finder installation kit provides everything you need for wiring up and powering a fishfinder on your rigid kayak without the Lowrance Ready feature. Kit includes Hobie's Rudder Ready* transducer mount, thru-hull plugs, 12V gel cell battery and charger, battery holder, wiring components and zip ties for tidying everything up.
*Not suitable for retractable Pro Angler style rudders.

- 72020229 FISHFINDER HOOK REVEAL 5 SPLIT
- 72020230 FISHFINDER HOOK REVEAL 7 SPLIT
- 72020231 FISHFINDER HOOK REVEAL 7 TRIPL
- 72023052 RAM FISH FINDER BASE W/ 1" ARM
- 72023054 RAM LOWRANCE BASE W/ 1.5" ARM
- 72023055 RAM LOWRANCE BASE W/ 1.5" ARM
- 72023060 RAM MOUNT 1" BALL & ARM HOOK2
- 72023061 RAM MOUNT 1.5" BALL & ARM HOOK

HOBIE EVOLVE

HOBIE EVOLVE POWERED BY TORQEEDO

This quiet and efficient electric motor will dramatically expand your horizons. With the Hobie evolve, you can either maintain steady cruising speeds of two knots (motor only) for hours, or you can open the throttle for short sprints. Best yet, depending on your set-up, you can use the evolve to augment your boat speed while also using your MirageDrive. And thanks to its cockpit-mounted Remote Throttle, you always know how much juice you have left in the system's Lithium-Manganese battery. Runtime estimated as 8 hr 20 min at 2.6 mph / 48 min full throttle using a 320 WH battery.

KIT INCLUDES:

Ready-to-go Mirage well-mounted Hobie evolve v2; All cables for the motor and throttle units; All mounting hardware; Assembly that integrates the motor with a Twist and Stow rudder*; Remote throttle system displays speed and distance information generated by an onboard GPS unit; Magnetic safety key; Waterproof fittings and cable connectors; Solar charging port; Corrosion-resistant materials ensure durability and performance; Lightweight power: Total weight of installed kit is 18 lbs (8.16 kg) or less, depending on the configuration. Order battery separately.

REMOTE THROTTLE

Remote Throttle, which attaches via a RAM mounting unit (included) to provide throttle control from your favorite seating position. The LCD screen displays all the trip info you need (such as speed and range) while you're underway. For safety, the unit features a magnetic key-to-throttle connection; break this magnetic connection and the motor immediately stops.

LITHIUM BATTERY V2

The batteries are buoyant and completely waterproof. Its built-in GPS unit generates pertinent information such as speed and range. Solar charge / run port.

MIRAGE WELL MOUNT

Mirage-mounted evolve weighs a scant 6.4 pounds—that's 0.2 pounds less than the MirageDrive.

2 for 1 BOTH MOUNTS INCLUDED

* Rudder Mount for all Mirage Series Kayaks with Twist and Stow Rudder Systems. Not Compatible with Inflatable Kayaks, Island Series or Pro Angler.

RUDDER MOUNT

A lightweight assembly to easily integrate the evolve motor with a Twist and Stow rudder. Pedal and motor; motor, or simply pedal. When off, the engine becomes your rudder or it can be brought on deck via the Twist and Stow controls. *(The rudder mount option is not compatible with inflatable series, Island series or Pro Anglers)*



Hobie Evolve V2



Rudder Mount



Remote Throttle



72022010 Torq Trac (Ltd stock)

TORQ TRAC

The dashboard for electric motors on your smartphone. Bluetooth accessory plugs in-line on the throttle cable and transmits a variety of great information to a smartphone. The App can be downloaded for free from the App store on your device.

Features:

Everything easily readable, even at night; Know how far you can still go: remaining range is shown on a map in real time; Uses waypoints for navigation and estimated time of arrival; GPS information; Trip logging and eco logging: see exactly how you're doing; Warning messages in plain language Individually adjustable.

- 72021133 REMOTE THROTTLE, TORQEEDO
- 72022032 EVOLVE v2 MOTOR KIT - K NO BAT
- 72022042 EVOLVE v2 MOTOR KIT - I NO BAT
- 72022126 EVOLVE BATTERY 333 Wh

- 72022132 CHARGER - 333 Wh BATTERY
- 72022141 EVOLVE BATTERY 915 Wh
- 72022142 CHARGER - 915 Wh BATTERY
- 72022010 TORQ TRAC



CA Residents: **WARNING:** Cancer and Reproductive Harm - www.P65Warnings.ca.gov

FISH FINDERS, MOUNTS & BATTERIES



Hobie Mirage Rigging Stand

HOBIE MIRAGE KAYAK RIGGING STAND

Place your kayak at a comfortable height for preperation of gear or while mounting hardware. Move the rack and boat around easily using a set of plug-in wheels as shown (not included). Multiple options for wheel use depending on your needs. The rack easily disassembles for flat storage. Not recommended for long term storage.

COMPASS FOOT BRACE KIT

Foot braces improve the user experience by offering more comfort and power while paddling from a seated position. The foot pads are easily adjustable to fit riders of various heights, and a trigger lock keeps the foot pad firmly in place while kayaking.

PASSPORT FISHFINDER FIT KIT

See Product Number Below

PASSPORT SIDESCAN FF PLATE KIT

See Product Number Below

HOBIE - LOWRANCE READY HUMMINBIRD ADAPTER

See Product Number Below



Hobie Rudder Ready Kit



Lowrance Ready Totalscan Plate

LITHIUM PRO POWER KIT

The perfect lithium ion power source for running your fish finder, GPS and other electronics! Nocqua's 12V, 10Ah Pro Power Kit is lightweight and compact, weighing in at just over 20 oz. It's safe, durable and water resistant and comes with all the components necessary for rigging up an individual device. Kit includes: 12V Lithium ion battery, 110V Charger, 12" connector with open leads, 6" heat shrink tubing and 2 heat shrink butt connectors.

HOBIE 12V BATTERY

Waterproof 9AH gel cell 12-volt battery with attached waterproof wiring and connectors, 12-volt battery charger.

HOBIE 12V BATTERY HOLDER

Hobie's battery holder is versatile! Hang inside an 8" Twist and Seal hatch or mount to the mast / accessory receiver inside the hull.

HOBIE THRU HULL WIRING KIT

Hobie thru hull fittings for routing wiring through cockpit area for FishFinders, GPS and more. Includes two through hull fittings with backing nuts, o-rings and one "tree" of adapters for different wire diameters. 3-Way version does not require backing ring for easier installation and allows larger cable end fittings to fit through a larger hole. Has 3 possible cable pass-through points.

ELEC CONNECTOR SET

Set of male / female waterproof plugs with wires and 4 waterproof (silicone filled wire nut) connectors.

HOBIE RUDDER READY KIT

Hobie's answer for outfitting your inflatable kayak with a fish finder. The Rudder Ready* kit allows you to securely mount a transducer to any kayak with a Twist and Stow style rudder system. Eliminates the need for over-the-side mounting arms, and simplifies transducer mounting on kayaks without the Lowrance Ready feature.

*Not suitable for retractable Pro Angler style rudders.

LOWRANCE® READY TOTALSCAN® PLATE

The Lowrance Ready TotalScan transducer plate mounts in the same location as the standard Lowrance Ready transducer plate found on your Hobie fishing kayak. This mounting plate leaves the TotalScan transducer free of obstruction, allowing the side imaging technology to function with optimal performance. A protective dome on the front end offers protection against head-on collision damage. *Transducer mounting hardware included.

- 72020150 FOOTBRACE KIT COMPASS/DUO
- 72020207 PLATE KIT, LOWRANCE READY TOTA
- 72020220 MOUNT KIT, TRIPLESHOT TRANSDUC
- 72021027 ELEC CONNECTOR SET
- 72025001 BATTERY - 12v FISHFINDER
- 72025002 CHARGER - 12v BATTERY FISH F
- 72025005 WATER PROOF WIRE CONNECTOR LG
- 72025007 HOLDER, 12v FF BATTERY

- 72025010 LITHIUM PRO POWER KIT 12V 10AH
- 72026217 FISHFINDER FIT KIT PASSPORT 12
- 77800048 SIDESCAN FF PLATE PASSPORT KIT
- 84505901 ADAPTER KIT, HUMMINBIRD FF
- 86505613 THRU HULL 3 WAY PLUG KIT
- 86505621 HOBIE THRU HULL WIRING KIT
- 87363222 FLOOR STAND, MIRAGE RIGGING

GET DECKED OUT FOR SERIOUS ANGLING HOBIE DECK PAD KITS



Scan code with
smartphone camera
for video link



72020239 MAT KIT, PASSPORT 12 GREY/CHAR
72020240 MAT KIT, PA12 GREY/BLACK 360
72020241 MAT KIT, PA12 BLACK/GREY 360
72020242 MAT KIT, PA14 GREY/BLACK 360
72020243 MAT KIT, PA14 BLACK/GREY 360
72020244 MAT, PA14 GREEN/ESPRESSO INTER
72020245 MAT, PA14 TITANIUM/BLUE INTER
72020246 MAT, PA14 GREY/CHARCOAL INTER
72020247 MAT, PA12 GREEN/ESPRESSO INTER

72020248 MAT, PA12 TITANIUM/BLUE INTER
72020249 MAT, PA12 GREY/CHARCOAL INTER
72020250 MAT KIT, PA14 GREEN/ESPRESSO
72020251 MAT KIT, PA14 TITANIUM/BLUE
72020252 MAT KIT, PA14 GREY/CHARCOAL
72020253 MAT KIT, PA12 GREEN/ESPRESSO
72020254 MAT KIT, PA12 TITANIUM/BLUE
72020255 MAT KIT, PA12 GREY/CHARCOAL
72020256 MAT KIT, OUTBACK GREEN/ESPRESSO

KAYAKING PARTS & ACCESSORIES: RECREATION & FISHING

BUILD YOUR PERFECT PLATFORM



Hobie Deck Pad Kits are custom-fit to every contour of your kayak and deliver comfort, traction and sound dampening qualities. The double layered, closed cell foam construction features a brushed finish for texture, and is mold, mildew and stain resistant. The strong adhesive backing adheres to the deck of your kayak for a semi-permanent installation. Complete kits provide overall coverage, and the best sound-dampening performance. Interior kits provide coverage on the recessed decking in the cockpit and cargo area, where you'll need it most.



72020257 MAT KIT, OUTBACK TITANIUM/BLUE
72020258 MAT KIT, OUTBACK GREY/CHARCOAL
72020260 MAT KIT, OUT 19 TI/AEG BL INTR
72020261 MAT KIT, OUT 19 TI/AEG BL COMP
72020263 MAT KIT, OUT 19 GRN/ESPR INTR
72020264 MAT KIT, OUT 19 GRN/ESPR COMP
72020266 MAT KIT, OUT 19 GRY/CHAR INTR
72020267 MAT KIT, OUT 19 GRY/CHAR COMP
72020305 MAT KIT, LYNX, 4MM GREY/CHARCO

Hobie

HOBIE.COM

CA Residents: **WARNING:** Cancer and Reproductive Harm - www.P65Warnings.ca.gov

POWER-POLE



1 - POWER-POLE MICRO AND SPIKE

Includes Micro Driver Unit and 8ft UL Spike. This all-electric unit is extremely quiet and easy to use. It works with a 3/4" spike to stop and anchor your kayak at the push of a button. It functions as a conventional stakeout pole or shallow water anchor without having to manually deploy it yourself. When the wind and water are moving, you won't be. With Power-Pole's signature strong hold, the Micro gives you a smooth stop on the spot in seconds. Whether you're anchored in sand, rock or mud - it's swift, silent, and secure.

2 - MOUNT KIT

Attach a Power-Pole Micro to the stern of your Hobie using the hardware and mounting plate that comes in this kit.

3 - LITHIUM BATTERY PACK

The Micro Battery Pak is not just any battery pack; it utilizes advanced Lithium-Ion technology to ensure the longest performance while maintaining the highest built-in safety standards. Delivering a minimum of 100 cycles per charge, it can easily handle a full day of excitement on the water. The Micro Battery Pak includes battery pack, mounting harness, AC wall adapter, and charger.

OR... 3 - HOBIE POWER KIT

Power up your Power-Pole Micro using this Hobie kit. Kit includes 12V battery, charger, battery holder, and all of the wire plugs, adapters and connectors.

INDIVIDUAL PARTS / SPARES:

Micro Driver Unit, Spikes, Mount Plates.



Power-Pole Micro and Spike



Outback Mount Kit



Hobie Power Kit



Hobie Stake-Out Pole



Anchor Kit



Hobie Drift Chute

- 72020009 HOBIE DRIFT CHUTE
- 72020073 TROLLEY KIT - TROLLEY READY OR
- 72020273 TROLLEY KIT - WELLNUT COMPASS/
- 72076001 STAKEOUT POLE - KAYAK FISHING
- 80035A ANCHOR w/BAG & LINE (3.5 LB)



HOBIE STAKE-OUT POLE

Hold position in shallow water by inserting the Hobie Stake-Out Pole into sand or mud. Fiberglass pole with metal tip, rubber grip handle and attachment line system.

HOBIE ANCHOR TROLLEY KIT

Easily deploy your anchor, drift chute or stake out pole over the side of the cockpit area, then move the attachment position forward or aft to hold your boat in the position desired. Easily sit facing down stream / wind at anchor. Simple pulley system and cleat allows adjustment all along one side of your boat anywhere from bow to stern. PA 12 and 2013+ PA 14s are "Trolley Ready" with molded-in fittings to mount the turning blocks.

ANCHOR KIT

3.5 pound folding anchor, bag and 60 feet of line. (Connect to the Hobie Anchor Trolley System for best results)

HOBIE DRIFT CHUTE

Large cone shaped "para" chute deployed in the water slows your drift in windy conditions when anchoring is not possible or desired. Design keeps chute just under the surface and fully inflated. Anchor line not included. (Connect to the Hobie Anchor Trolley System for best results)



H-BAR



ADJUSTABLE H-BARS

Standing support for Kayaks! The adjustable H-Bar will integrate with all H-Rail accessories for easy customization. It folds up when you need it and away when you don't. The aluminum extrusion is strong and lightweight for leaning against or holding on to while entering/exiting the boat or pulling yourself up from a seated to a standing position. The Outback Universal kit is fully adjustable to fit a wide variety of kayaks. The PA17 requires an adapter kit (extra set of H-Rail clamps and a longer center bar) when used in the middle and aft seat positions.

- Lean against to stabilize
- Pull yourself up from a seated position
- Grab ahold to assist when entering the kayak
- Variable height settings
- Folds out of the way

- 84500116 HOBIE H-BAR / PRO ANGLER
- 84500117 HOBIE H-BAR / COMPASS
- 84500119 HOBIE H-BAR, OUTBACK / UNI
- 84500120 HOBIE H-BAR, OUTBACK 2019+
- 84500121 HOBIE H-BAR PASSPORT 12
- 84500122 H-BAR LYNX



H-RAIL EXTRUSION
Integrates with all H-Rail accessories, like rod holder mounts, for easy customization.

ADJUSTABLE
Four telescoping legs, along with foot-mount placement, enable a wide range of height settings.

INCLUDES
Mounts
Hardware

Weight
4.5 lb / 2.04 kg

MAINTENANCE



HOBIE MULTI-LUBE

A planet-safe lubricant recommended for lubricating MirageDrives and many other uses. Environmentally friendly for in-the-water applications. Hobie Multi-Lube offers excellent lubrication, is an anti corrosive coating, great for cleaning and many other uses... use on nearly anything that squeaks, rusts, corrodes or binds up; MirageDrives, rudder drums, cams, fishing reels and more. The 1 oz size is perfect for getting the lubricant into tight spaces by using the needle applicator. The 4 oz size has a spray applicator for coating chains and larger surfaces, shafts and bulky parts. Every Hobie owner should have Hobie Multi-Lube. Be nice to our planet, keep MirageDrives and other components running smoothly and lasting longer without polluting our waterways. Use it for all shop, home and sport lubrication needs.

SILICONE SPRAY

Dry silicone spray for cleats, hatch O-rings. (Image above may not represent current packaging or volume)

HOBIE UV PROTECTANT

Protect and rejuvenate fiberglass, polyethylene, vinyl and PVC materials. Wipe on, the protectant absorbs into the material and leaves a UV protective layer. Reduce the loss of essential oils and deflect the sun's harmful UV rays. 12 oz.

MAGICA RUST REMOVER

Easily clean rust stains from fiberglass, plastic surfaces, metal parts or fabrics. Although metal parts are made from high quality stainless steel, machining tools often leave carbon particles imbedded in the metal surfaces. This material can bleed a rust stain onto other surfaces. Magica simply dissolves the rust away.

CLEAR SILICONE SEALER

Make sure your hulls are watertight! Clear Silicone seals leaks around all thru-hull fittings.

SAIL REPAIR TAPE

Don't get caught with your sails down! Extra strong, Rip Stop white tape for temporary on-the-spot repairs to torn sails, canvas, even foul weather gear. Keep a roll in your toolbox for emergencies.

AQUASEAL MIRAZYME ODOR ELIMINATOR

There's nothing quite like the odor of damp gear left in your car trunk for a couple of days. With one application eliminate those odors from booties, wet-suits, dry-suits and the rest of your gear. A 100% biodegradable product made from a blend of 10 highly specialized, light activated microbial elements. Works by penetrating into pores of fabric, rubber and even hard surfaces to eliminate odor naturally. (Packaging may vary)

- 1603 MAGICA RUST REMOVER GEL 8 OZ B
- 1662 TAPE, SAIL REPAIR 2"X 25' ROLL
- 5107 SILICONE SPRAY 7oz
- 5120 HOBIE MULTI LUBE 1 OZ
- 5121 HOBIE MULTI LUBE 4 OZ



Hobie Multi-Lube



Silicone Spray



Magica Rust Remover



Clear Silicone Sealer



Tear-Aid



Hobie UV Protectant

TEAR-AID

Each TEAR-AID® repair patch is made from an exceptionally tough, matte finish, abrasion resistant, elastomer that resists puncture and tearing. It is combined with an aggressive adhesive formulated for high bond strength to a variety of surfaces such as canvas, leather, rubber, nylon, most plastics, paints, aluminum, stainless steel, fiberglass, polyurethane, polyethylene, polypropylene, vinyl and vinyl coated. TEAR-AID® Type A and TEAR-AID® Type B provide a simple and easy method of patching holes and tears, as well as an excellent protective film solution.

EACH PATCH KIT CONTAINS:
(1) 3" x 12" TEAR-AID® Patch that cuts with scissors to any size, (1) 7/8" x 7/8" Patch, (1) 1 3/8" x 1 3/8" Patch, (1) 12" Reinforcement Filament for repairing tears at edges, (2) Alcohol Prep Pads, (1) Illustrated Instructions and a Product Repair List.

- 7003 REVIVEX 10 oz ODOR ELIMINATOR
- 8000231 SILICONE RTV 100% 3 OZ
- 70060001 HOBIE UV PROTECTANT-12oz
- 72020030 TEAR-AID / TYPE A (POLY)
- 72020031 TEAR-AID / TYPE B (VINYL)



MIRAGE ECLIPSE

MIRAGE ECLIPSE ACCESSORY BAG

The Mirage Eclipse experience just got even better! Now you can take your essentials along with you by packing them away in this convenient Eclipse Accessory Bag.

- Eclipse Accessory Bag Features:
- 3 easy Velcro straps for attachment to the Eclipse handle bar
 - Water resistant construction for keeping things dry
 - Key tether with YKK snap swivel for extra security
 - Interior zipper pouch for organizing smaller items
 - Drainage hole in the bottom of the bag to rid water and keep the interior of the bag dry
 - Clear visibility window in the top of the bag so you know exactly what you're reaching for
 - Dimensions: approx. 8" Tall x 8" Wide x 3" Deep

UNIVERSAL MOUNT & CAGE

Stay hydrated! This awesome mount with water bottle cage allows you to carry a water bottle on the Eclipse handlebar tubing. Adjustable for upper or lower tube size. Quick attachment and removal.

QUAD LOCK UNIVERSAL PHONE MOUNT

The Quad Lock adapter allows you to mount a phone or small device to Handlebars, H-Rail, H-Bar tubing. Designed for biking, but great for Hobie rail attachment too! Quick 45 degree twist to attach and lock. Release spring lever and turn 45 degrees to remove the device from the mount. Attaches to rails with rubber rings or zip ties that are included in the kit. 3M adhesive adapter attaches securely to your device (water proof cases recommended of course).



Eclipse Accessory Bag



Universal Mount & Cage

Phone Mount

HOBIE SUP / MSUP LEASH

Safety leash worn above your calf leashes you to your board in case you fall off. 8' Coil.

PADDLE "T" HANDLE

Convert your kayak paddle to a canoe style paddle. Easier to store on many models of Hobie Mirage kayaks where paddle use is unnecessary while using the MirageDrive. Plugs into the female half of the kayak paddle.

TELESCOPING PADDLE

Measures just 20" in closed position (45" when fully extended). Lightweight, anodized aluminum shaft corrosion resistant design. Floats too! 6 1/2" wide blade will fit into an 8" hatch opening.

3 PC FIBERGLASS PADDLE

Carry as a spare or emergency paddle. 3 piece easily assembles when needed. Includes carry bag.

PADDLE LEASH

Secure a paddle to your boats bow eye. Keep the paddle with the boat after a capsize. By holding the paddle after a capsize you can also be sure that the boat stays with you and cannot drift away. Web paddle leash is made from hollow webbing and an internal shock cord. Coil leash is elastic plastic coil.



Hobie SUP / MSUP Leash



Paddle "T" Handle



Web 4.5" and Coil Paddle Leash

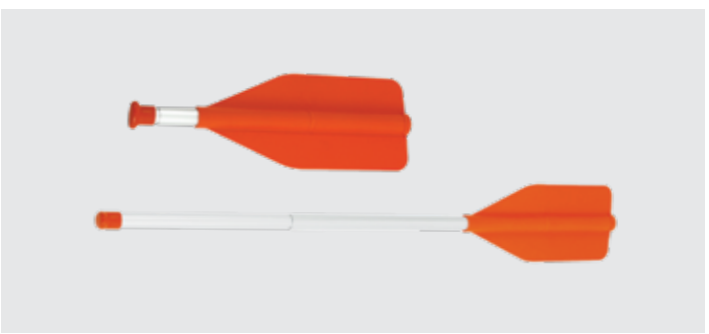

Telescoping Paddle



- 72020116 ECLIPSE ACCESSORY BAG
- 72020504 WATER BOTTLE HOLDER KIT ECLIPS
- 72020511 QUAD LOCK UNI PHONE MOUNT

- | | | | |
|----------|------------------------------|-----------|-------------------------|
| 3091 | PADDLE, TELESCOPING 20"-3'9" | 74051001 | PADDLE LEASH-COIL |
| 74048 | T-HANDLE PADDLE - 2019+ | 470145-10 | HOBIE SUP LEASH COIL 8' |
| 74050001 | PADDLE LEASH-WEB/ELASTIC | | |



CA Residents: **WARNING:** Cancer and Reproductive Harm - www.P65Warnings.ca.gov

100% POLARIZED SUNGLASSES

Since 1982, the most demanding water enthusiasts have relied on Hobie Eyewear’s premium polarized lenses & durable frames to deliver unparalleled performance and optimal visual clarity, no matter the adventure.

LIFETIME WARRANTY

NO-HASSLE, FRIENDLY, LIFETIME WARRANTY FOR RETAILERS AND CONSUMERS
Hobie Eyewear sunglasses are warranted to the original registered purchaser against defects in materials and workmanship for the LIFETIME of the sunglass. Take advantage of servicing your customer directly or sending them to Hobie Eyewear for warranty services.
To learn more, visit www.hobieeyewear.com/warranty.

FLOATING COLLECTION

Water and adventure ready, the Hobie® Eyewear FLOATING COLLECTION offers significantly lighter frames than compared to standard frames, allowing these sunglasses to float when out on the water. To ensure comfort for long-term wear in any environment, Floating Collection frames are highly durable and heat-resistant.

BLUEFIN-B010138



BLUEFIN FLOAT

- BLUEFIN-B010108 SATIN BLACK - GREY POLARIZED - **NEW**
- BLUEFIN-B010126 SATIN BLACK - SEA GREEN MIRROR POLARIZED - **NEW**
- BLUEFIN-B010138 SATIN BLACK - SIGHTMASTER™ PLUS POLARIZED - **NEW**
- BLUEFIN-B010168 SATIN BLACK - COBALT MIRROR POLARIZED - **NEW**

SPECS / FEATURES:
Fit: XXL; Measurements: 63-18-130 (Eye-Bridge-Temple)
8 Base; Nylon lenses; HydroClean™ 360° Polarized Technology;
Signature lightweight floating frame; Co-molded megol rubber;
Integrated hinges; Prescription Friendly (with Trivex or high index lenses. Recommended within +/- 4.00 prescription.)

MOJO-B010168



MOJO FLOAT

- MOJO-B010138 SATIN BLACK - SIGHTMASTER™ PLUS POLARIZED - **NEW**
- MOJO-B010168 SATIN BLACK - COBALT MIRROR POLARIZED - **NEW**
- MOJO-B010188 Satin Black - SEA GREEN mirror Polarized
- MOJO-B292928 SHINY BROWN WOOD GRAIN - COPPER Polarized

SPECS / FEATURES:
Fit: Extra Large; Measurements: 67-18-120 (Eye-Bridge-Temple)
8 Base; Nylon lenses; HydroClean™ 360° Polarized Technology;
Signature lightweight floating frame; Integrated hinges; Prescription Friendly (with Trivex or high index lenses. Recommended within +/- 4.00 prescription.)

MONARCH-B010126



MONARCH FLOAT

- MONARCH-B010108 SATIN BLACK - GREY POLARIZED - **NEW**
- MONARCH-B010126 SATIN BLACK - SEA GREEN MIRROR POLARIZED - **NEW**
- MONARCH-B010158 SATIN BLACK - SUNSET MIRROR POLARIZED - **NEW**
- MONARCH-B171768 SATIN METALLIC - COBALT MIRROR POLARIZED - **NEW**

SPECS / FEATURES:
Fit: Medium/Large; Measurements: 53-20-126 (Eye-Bridge-Temple)
6 Base; Polycarbonate lenses; HydroClean™ 360° Polarized Technology;
Signature lightweight floating frame; Integrated hinges; Removable side shields & adjustable retainer included; Prescription Friendly (with Trivex or high index lenses. Recommended within +/- 4.00 prescription.)

COASTAL-B010158



COASTAL FLOAT

- COASTAL-B010168 Satin Black - Cobalt Mirror Polarized
- COASTAL-B010126 Satin Black - SEA GREEN Mirror Polarized
- COASTAL-B010158 Satin Black - SUNSET Mirror Polarized

SPECS / FEATURES:
Fit: Medium/Large; Measurements: 54-18-138 (Eye-Bridge-Temple)
6 base, Nylon lenses; HydroClean™ 360° Polarized Technology;
Signature lightweight floating frame; Integrated hinges; Prescription Friendly (with Trivex or high index lenses. Recommended within +/- 4.00 prescription.)

CABO-50PGY



CABO

- CABO-50PGY SHINY Black - GREY Polarized
- CABO-58PCP SHINY BROWN WOOD GRAIN - COPPER Polarized

SPECS / FEATURES:
Fit: Medium; Measurements: 60-16-125 (Eye-Bridge-Temple)
8 Base; Polycarbonate lenses; HydroClean™ 360° Polarized Technology;
TR-90; Precision flex hinges; Prescription Friendly

WRIGHTS-000008



WRIGHTS

- WRIGHTS-000008 SHINY Black - GREY Polarized
- WRIGHTS-141458 SHINY CRYSTAL CLEAR - SUNSET Mirror Polarized
- WRIGHTS-949428 SHINY BROWN TORTOISE - COPPER Polarized

SPECS / FEATURES:
Fit: Medium/Large; Measurements: 48-22-146 (Eye-Bridge-Temple)
6 Base; Polycarbonate lenses; HydroClean™ 360° Polarized Technology;
TR-90; 3 Barrel hinges; Prescription Friendly

IMPERIAL-000008



IMPERIAL - FOLDING FRAME

- IMPERIAL-000008 SHINY BLACK - GREY Polarized
- IMPERIAL-000068 SHINY BLACK - COBALT Mirror Polarized

SPECS / FEATURES:
Fit: Medium; Measurements: 55-17-136 (Eye-Bridge-Temple)
6 Base; Polycarbonate lenses; HydroClean™ Polarized Technology;
Multi-integrated hinges; Megol rubber nose pads; Compact Neoprene carrying case included; Prescription Friendly

MAYWOOD-289428



MAYWOOD

- MAYWOOD-009208 SHINY Black - GREY W. SILVER FLASH Polarized
- MAYWOOD-289428 SHINY TORTOISE - COPPER W. SILVER FLASH Polarized

SPECS / FEATURES:
Fit: Medium; Measurements: 54-18-142 (Eye-Bridge-Temple)
6 Base; Polycarbonate lenses; HydroClean™ Polarized Technology;
TR-90; 3 Barrel hinges; Prescription Friendly

BODHI-010168



BODHI

- BODHI-010108 Satin Black - Grey Polarized - **NEW**
- BODHI-010168 Satin Black - Cobalt Mirror Polarized - **NEW**
- BODHI-141408 SHINY CRYSTAL CLEAR - Grey Polarized - **NEW**
- BODHI-141468 SHINY CRYSTAL CLEAR - COBALT Mirror Polarized - **NEW**

SPECS / FEATURES:
Fit: Large; Measurements: 57-16-132 (Eye-Bridge-Temple)
6 Base; Polycarbonate lenses; HydroClean™ Polarized Technology;
TR-90; Integrated hinges; Co-molded megol rubber; Prescription Friendly



ELMATADOR-010138



EL MATADOR

- ELMATADOR-010108 Satin Black - Grey Polarized
- ELMATADOR-010138 Satin Black - SIGHTMASTER™ PLUS Polarized - **NEW**
- ELMATADOR-010126 Satin Black - SEA GREEN Mirror Polarized - **NEW**
- ELMATADOR-010168 Satin Black - COBALT MIRROR Polarized - **NEW**

SPECS / FEATURES:
Fit: Large; Measurements: 61-15-130 (Eye-Bridge-Temple)
8 Base; Polycarbonate lenses; HydroClean™ 360° Polarized Technology;
Retracting side shields; TR-90; Integrated hinges, Co-molded megol rubber; Prescription Friendly

EVGLADE-010126



EVERGLADES

- EVGLADE-010108 Satin Black - Grey Polarized
- EVGLADE-010168 Satin Black - Cobalt Mirror Polarized
- EVGLADE-010126 Satin Black - SEA GREEN Mirror Polarized
- EVGLADE-010138 Satin Black - SIGHTMASTER™ PLUS Polarized
- EVGLADE-282828 SHINY DARK BROWN TORT - COPPER POLARIZED - **NEW**

SPECS / FEATURES:
Fit: Large; Measurements: 63-18-129 (Eye-Bridge-Temple)
8 Base; Polycarbonate lenses; HydroClean™ 360° Polarized Technology;
TR-90; Integrated hinges; Co-molded megol rubber; Prescription Friendly

SNOOK-010108



SNOOK

- SNOOK-010108 Satin Black - Grey Polarized
- SNOOK-010168 Satin Black - Cobalt Mirror Polarized
- SNOOK-010126 Satin Black - SEA GREEN Mirror Polarized
- SNOOK-010138 Satin Black - SIGHTMASTER™ PLUS Polarized
- SNOOK-282828 SHINY DARK BROWN TORT - COPPER POLARIZED - **NEW**

SPECS / FEATURES:
Fit: Medium; Measurements: 60-17-132 (Eye-Bridge-Temple)
8 Base; Polycarbonate lenses; HydroClean™ 360° Polarized Technology;
TR-90; Integrated hinges; Co-molded megol rubber; Prescription Friendly

WOODYSP-000008



WOODY SPORT

- WOODYSP-000008 SHINY BLACK - GREY POLARIZED - **NEW**
- WOODYSP-010158 SATIN BLACK - SUNSET Polarized - **NEW**
- WOODYSP-959528 SHINY TORTOISE - COPPER Polarized - **NEW**

SPECS / FEATURES:
Fit: Medium; Measurements: 60-17-132 (Eye-Bridge-Temple)
6 Base; Polycarbonate lenses; HydroClean™ 360° Polarized Technology;
TR-90; Integrated hinges; Sweat resistant megol rubber temple padding; Prescription Friendly

MIRAGEDRIVE GT / V2

FIND HOBIE MIRAGEDRIVE 180 DIGRAMS AT HOBIE.COM/SUPPORT



WHAT MAKES A GT Drive? V2 Drums, V2 Chains, GT Idler Pulley, V2 Idler Cable, GT sprockets and V2 (Threaded) masts

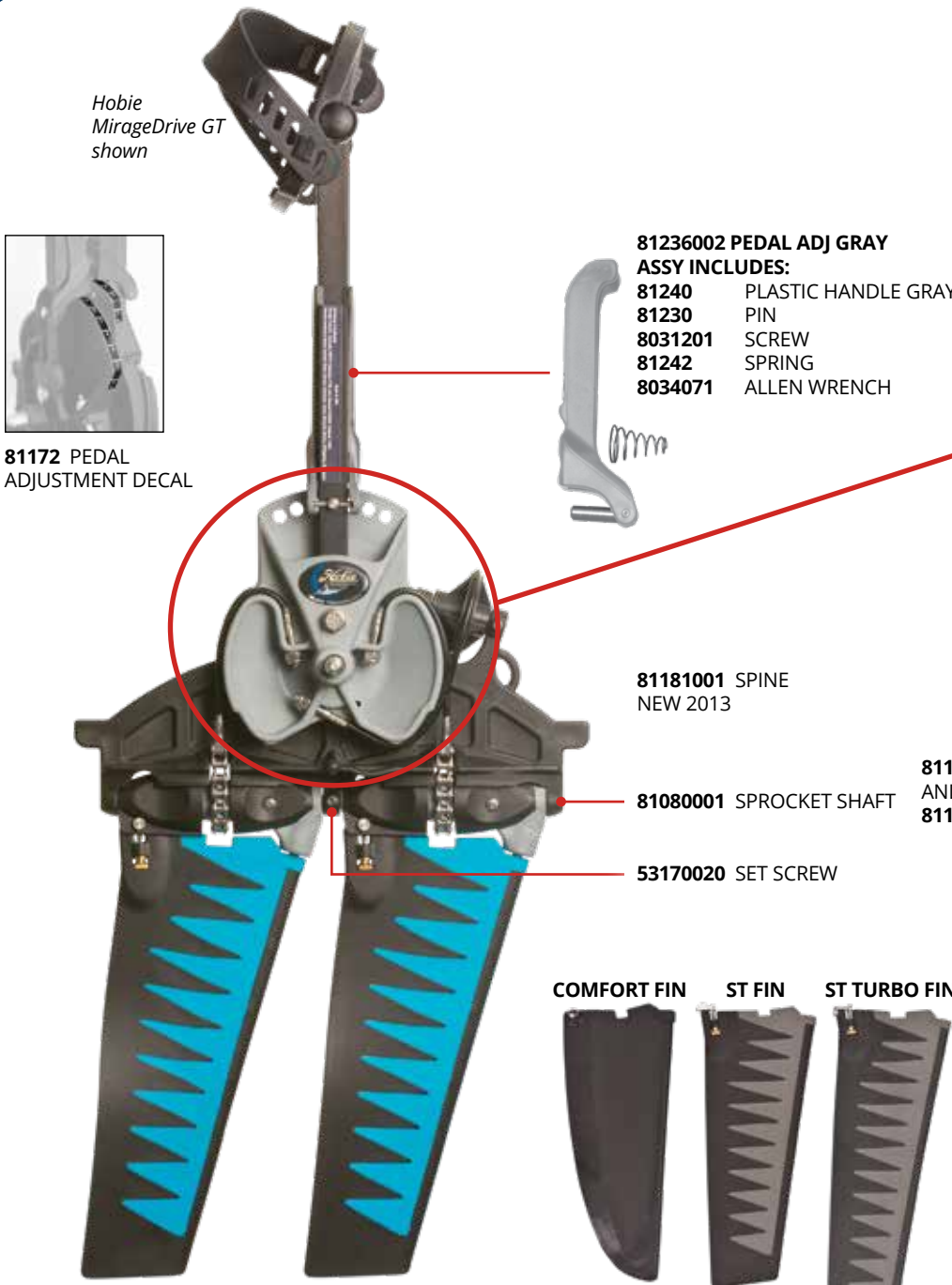

Hobie MirageDrive GT shown



81172 PEDAL ADJUSTMENT DECAL

- 81236002 PEDAL ADJ GRAY ASSY INCLUDES:**
- 81240 PLASTIC HANDLE GRAY
 - 81230 PIN
 - 8031201 SCREW
 - 81242 SPRING
 - 8034071 ALLEN WRENCH

- 81222 PEDAL/CRANK ASSY. GRY (R)
- 81221 PEDAL/CRANK ASSY. GRY (L)
- 81222011 PEDAL ONLY (R)
- 81221011 PEDAL ONLY (L)
- 81226001 PEDAL STRAP (R)
- 81227001 PEDAL STRAP (L)
- 81222101 CAP - PEDAL CRANK
- 81222111 CAP - PEDAL
- 8050110 NUT
- 8080541 WASHER

- 81055 SPROCKET GUARD FWD
- 8031450 SCREW
- 81050001 OUTHAUL BLOCK
- 8020040 CLEVIS PIN
- 10860000 LOCK RING

- 81181001 SPINE NEW 2013

- 81127001 SPROCKET GT THREADED (W/ BEARINGS AND FWD GUARD)
- 81156301 SPROCKET BEARINGS (12)

- 81163 MAST V2 THREADED
- 81198 MAST / ST TURBO V2 THREADED
- 8000341 LOC-TITE .5ML



- 81190001 COMFORT FIN
- 81193001 ST FIN (GRY/BLK)
- 81193021 ST FIN (RED/BLK)
- 81193 (BLU/BLK)
- 81192 (GRY/BLK)
- 81192021 ST FIN (RED/BLK)
- 81194 (BLU/BLK)

HOBIE MIRAGEDRIVE "GLIDE TECHNOLOGY"

80013501 MIRAGE DRIVE GTi - ST FINS iSeries

UPDATE KIT - GT SPROCKET
(2 GT SPROCKETS AND 2 V2 MASTS)
81129023 GT STANDARD MAST KIT
81129123 GTT TURBO MAST KIT

UPDATE KIT - V1 DRUMS/CABLES TO GT
(2 GT DRUMS, V2 CHAINS, GT IDLER PULLEY, V2 IDLER CABLE AND NUTS)
81171002 DRUM UPDATE KIT V1 TO GT

- 81175 DRUM GT W/ BEARINGS
- 81156401 DRUM BEARINGS (15)
- 81202 CHAIN ASSY V2
- 8050110 NUT
- 81090001 DRUM SHAFT V2 FITS ALL MODELS
- DRIVE SEAL**
- 81037001 STD
- 81038001 I - SERIES
- 8031580 SCREW
- 8080460 WASHER
- 81155001 BOLT

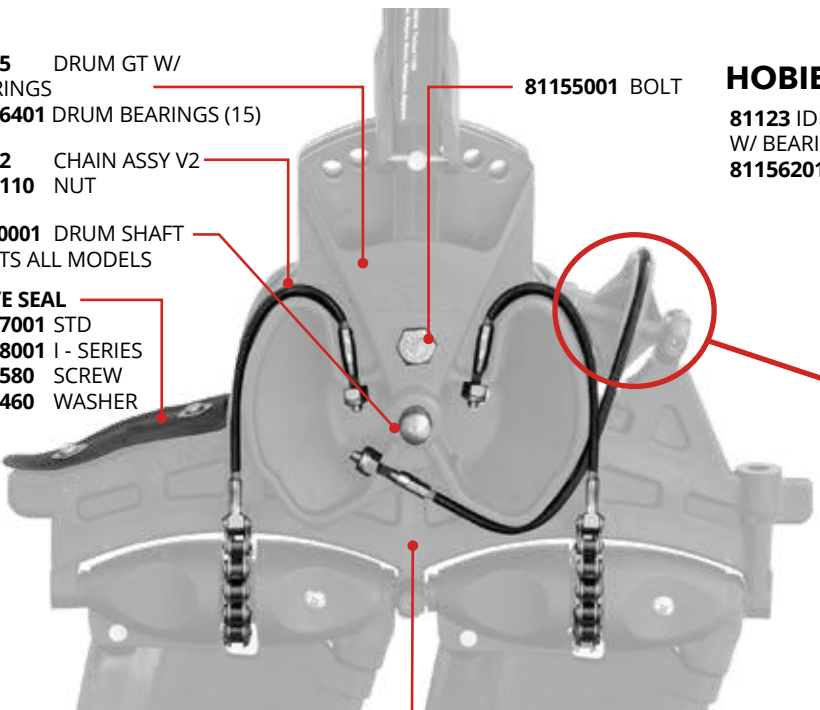

81095 DRIVE ALIGNMENT PIN 2012+

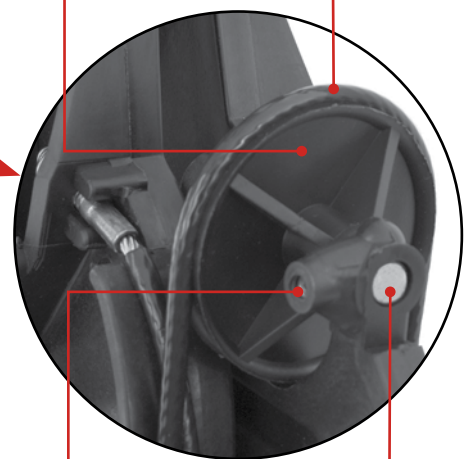

53170020 SET SCREW 81110001 PULLEY SHAFT

HOBIE MIRAGEDRIVE "V2" / "GT"

- 81123 IDLER PULLEY GT W/ BEARINGS
- 81156201 IDLER BEARINGS (12)
- 81203 IDLER CABLE V2 (17.2")
- 8050110 NUT

HOBIE MIRAGEDRIVE 180

- 81183 MIRAGEDRIVE ARC 180 - ST FINS
- 81185 MIRAGEDRIVE ARC 180i- ST FINS iSeries
- 81184 MIRAGEDRIVE ARC 180 - ST TURBO FINS

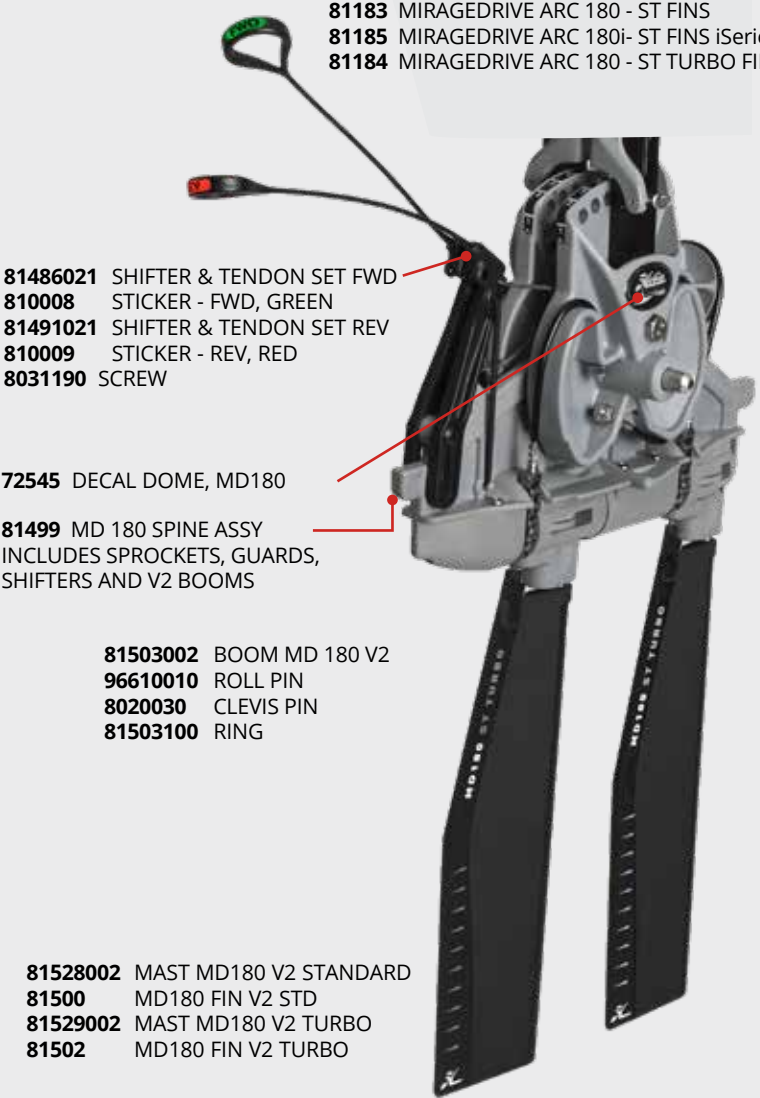

- 81486021 SHIFTER & TENDON SET FWD
- 810008 STICKER - FWD, GREEN
- 81491021 SHIFTER & TENDON SET REV
- 810009 STICKER - REV, RED
- 8031190 SCREW

72545 DECAL DOME, MD180

81499 MD 180 SPINE ASSY INCLUDES SPROCKETS, GUARDS, SHIFTERS AND V2 BOOMS

- 81503002 BOOM MD 180 V2
- 96610010 ROLL PIN
- 8020030 CLEVIS PIN
- 81503100 RING

- 81528002 MAST MD180 V2 STANDARD
- 81500 MD180 FIN V2 STD
- 81529002 MAST MD180 V2 TURBO
- 81502 MD180 FIN V2 TURBO



MAINTENANCE AND TUNING - Maintenance and tuning information for MirageDrives is available on the Hobie Cat website support area. Click the kayak model name then see Care and Maintenance. Direct link to the support pages for kayaks is here: <http://www.hobie.com/support/>

HOBIE MIRAGEDRIVE -OLDER-

Original drive with aluminum spine, stainless sprocket / mast connection is cotter key. Limited parts available.

- 81130001 SPROCKET (STAINLESS)
- 8060110 COTTER KEY (MAST / SS SPKT)
- 8020060 CLEVIS PIN
- 10860000 LOCK RING
- 81211001 IDLER CABLE 14 3/4" (SOLID PULLEY)

MIRAGEDRIVE SPARE PARTS KITS

Spare parts kits include a fin, mast, sprocket, chain and appropriate parts for the drive version. Older drives have sprockets and masts that use a set screw connection. V2 drives use threaded sprockets and masts. All in a handy zippered pouch. Don't waste a day on the water when your MirageDrive could be easily repaired. Available for the standard fin drive or a drive with the ST Turbo fins. Standard kit shown.

MIRAGEDRIVE GT (THREADED MAST)

- 80010401 GT ST (Bearing Sprocket)
- 80013401 GT TURBO (Bearing Sprocket)

KAYAK PARTS

36370050 HATCH SEAL "TRIM-LOC"
(TOP MOLDED) 5' REQ

71305 HATCH SEAL LG BULB "TRIM-LOC"
(TOP MOLDED) OUTBACK 5'

71302001 HULL FLANGE SEAL (PRE 2012 ADV)
"TRIM-LOC" (SIDE GLUED) 5' REQ

84560 MAST RECEIVER COVER
8031150 SCREW

84550 MAST RECEIVER

81450 HOBIE CHEEK BLOCK

80012001 PEDAL RETAINER BUNGEE w/ HOOK

78561001 HOOKLESS STOWAGE POCKET
78565001 HOOKLESS POCKET W/FRAME
8031501 SCREW

71220 METAL PAD EYE
8030070 SCREW

76050 BOW/ STERN HANDLE

72542 DOME STICKER 1.75"

74043 PADDLE 2-PIECE FIBER SHAFT 230 CM
74044 PADDLE 2-PIECE FIBER SHAFT 260 CM
(Only sold as matched set)

74076101 BUTTON PLASTIC
74076102 BUTTON SS

74030002 DRIP RING FG SHAFT

74010 REPLACEMENT BLADE RIGHT
74011 REPLACEMENT BLADE LEFT

74049 PADDLE "T" HANDLE
74048 PADDLE "T" HANDLE =>2019

38120030 PUSH-IN CAP (White)
(Underside Of Hull)

10730010 CLEAT
8030110 SCREW

2103 SHOCKCORD END
8031130 SCREW

81537 MIRAGE CASSETTE PLUG

8031570 SCREW / PADDLE KEEPER BUNGEE
79538201 WEB PULL TAB

81611201 (R)

81611101 CLICK AND GO ASSY (L)
8161201 CLICK AND GO ASSY (R)

8030791 SCREW
(REQUIRES 3/16" allen "BALL-END" wrench)

816021 SPRING CLICK AND GO LEFT
816022 SPRING CLICK AND GO RIGHT

2008 AND OLDER
81410001 CAM LOCK KNOB
BOLTS VARY BY MODEL

SEE MIRAGEDRIVE PAGE
FOR DRIVE DETAILS

8004531 LINE (BLK)
81450 HOBIE CHEEK BLOCK
8031065 10-32 x 7/8 SCREW
8031069 10-32 X 1-1/4 SCREW (AI)
8050210 NUT

81408 HANDLE
81406 HANDLE CAP - UP
81407 HANDLE - DOWN

81408001 OLDER HANDLE
81407001 OLDER DECAL - DOWN

10730031 "PORT" SHOWN

1073002 CLEAT STBD
1073003 CLEAT PORT
8031541 SCREW

OLDER UP / DOWN

81392001 TWIST AND STOW CONTROL ARM UP/DOWN
81380001 OLDER - CONTROL ARM UP/DOWN
8080690 NYLON WASHER

RUDDER - STEERING

STEERING CRANKS
81014 SPORT/REV 11
81016 REV 13
81017 OUTFIT / OB / OASIS
88991284 AI 2011+/TI
810175 2015+ OASIS
88991420 2015+ AI

CRANKS MAY REQUIRE SIMPLE BEND
MODIFICATION FOR USE. MODELS
VARY.

STEERING
81013 STEERING HANDLE
8030126 SCREW
88991052 STICKER
81385 WASHER
88991235 PIN
60330050 SPRING

88991355 KNOB ASSY
(Handle not included)

81372001 CRANK OLDER AI-OUTFIT
6033050 SPRING
8080690 NYLON WASHER

KAYAK PARTS CONTINUED

OLDER MIRAGE SERIES SEAT

- 81269001 MIRAGE BACKREST - TWIST LOCK
- 81268001 MIRAGE BACKREST - EXPAND PEG
- 81259001 SEAT STRAP w/ HOOK



- 71190000 WEBBING LIFT HANDLE (WEB WITH HOLE)
- 8032010 SCREW
- 8080570 WASHER

- 76055 MIDSHIP HANDLE
- 8032011 SCREW

- 8899106 MIDSHIP HANDLE
- 803201 SCREW



71190031 HANDLE - SIDE CARRY KIT. Designed for compass but can be used anywhere you have internal hull access for hardware installation. Pair of handles and hardware.

- 41220000 EYELET POST
- 8031130 SCREW

- 53180010 3/8" HOG RING
- 21180100 1/2" HOG RING

- 78520001 EYELET HOLD DOWN
- 8032121 SCREW

- 8004791 1/8" SHOCKCORD
- 8004830 3/16" SHOCKCORD
- 8004810 1/4" SHOCKCORD
- 79538201 WEB PULL TAB

- 8030030 SCREW
- 8012000 RIVET

- 711200 LASHING HOOK
- 8030030 SCREW

- 78510001 BUNGEE HOOK
- 8031961 SCREW

- 81272 SHOCKCORD HOOK, 1/4"

- 81277 HANDLE
- 81245 ROLL PIN
- 81276 TWIST-LOC

81276201 TWIST-LOC SEAT KIT (PAIR)
(Fit Older Seat Into Twist Loc Hull)

81275 TWIST-LOC RECEIVER* (IN HULL)
*REPLACEMENT PART ONLY - NOT
RECOMMENDED AS AN UPGRADE

OLDER SEAT PEGS



- 81265101 SEATBACK
ADJUSTABLE PLUG KIT (PR)



- 81265001 SEATBACK PLUG
- 8031130 SCREW
- 8080541 WASHER

PADDLE SERIES SEAT



- 72402001 SEATBACK / PADDLE MODELS 2010
- 72409001 SEAT STRAP W/HOOK



- 10092030 PLUG
(Seat area of Adventure,
Kona, Outfitter, Revolution)



- 72009001 Scupper plug
(Pursuit/ Maui/ Lanai)



- 72010 Scupper plug
(Odyssey)

LOWER SPEED DRAIN ASSEMBLY
FAIRING, O-RING, SHOCK CORD
71114001 OUTFITTER-FRT
71114002 SPORT-OASIS-TI
71114003 REVO 11 FRONT
71114004 REVO 13 FRONT
71114005 REVO 16
71114006 OASIS FRONT

- 71113001 DRAIN PLUG
- 8004531 BLK LINE (2')
- 71122 CLEAT - SCREW IN
- 81408 HANDLE
- 814014 HANDLE CAP "DRAIN"
- 8030232 SCREW



- 71230001 ROD HOLDER COVER
- 8031130 SCREW



- 72012001 SCUPPER PLUG
(QUEST / KONA / OUTBACK)

HATCHES



- 71701011 HATCH 6" TWIST AND SEAL
- 71701001 HATCH 6" TWIST AND SEAL RETRO KIT
- 71321001 FLANGE GASKET
- 71701021 LID O-RING
- 8031130 SCREW



- 77800020 HATCH 8" TWIST AND SEAL
- 71702001 HATCH 8" TWIST AND SEAL RETRO KIT
- 71331001 FLANGE GASKET
- 71702021 LID O-RING
- 8031130 SCREW

TECH TIP

DECK FASTENERS - Customize your boat with the fasteners of your choice... where you want them. The Hobie screw-in fittings can be easily removed and replaced. Add an extra eye where we placed a hook, a cleat hook where a shockcord end is placed... You choose what works best for you.

Use tool #71115101

SCREW-IN FITTINGS



- 71116001 PADEYE



- 71125 PADEYE XL



- 71117001 CLEAT



- 71115001 SHOCKCORD END



- 71124 PLUG SOLID



- 71115101 TOOL SCREW IN FITTINGS

KAYAK PARTS CONTINUED

- 10091000 DRAIN PLUG W/ O-RING

10092020 O-RING
- 79052012 DRAIN PLUG W/ O-RING

79050212 O-Ring



- LINE AND TUBE ASSEMBLY
- 80025001 LINE CONTROL ASSY. LINE IN TUBE WITH END CAPS (1)
- 80020001 UNIVERSAL LINE REPLACEMENT KIT (SET OF 4 AND ADDITIONAL LINE)



- 81023000 SPECTRA CONTROL LINE
- 8063001 SWEDGE
- 81400001 TUBING
- 81405 TUBE HOLDER
- 81402 END CAP
- 81403 "O" RING

EARLY RUDDER PARTS

- NYLON RUDDER PIN

81361001 CLASSIC

81362001 OLDER OUTBACK

81362001 OLDER SPORT

81362001 OLDER TANDEM

20860010 LOCK RING
- 81350 RUDDER MOUNT

81390001 RUDDER BLADE
- 81360001 S.S. RUDDER PIN

8030170 SCREW

8080541 WASHER

TECH TIP

MAINTENANCE AND TUNING - Maintenance and tuning information for Twist and Stow rudder systems is available on the Hobie Cat website support area.
<http://www.HOBIE.COM/support/history/>
Direct link to the support pages for kayaks is here:
<http://www.HOBIE.COM/support/products/kayaks/>

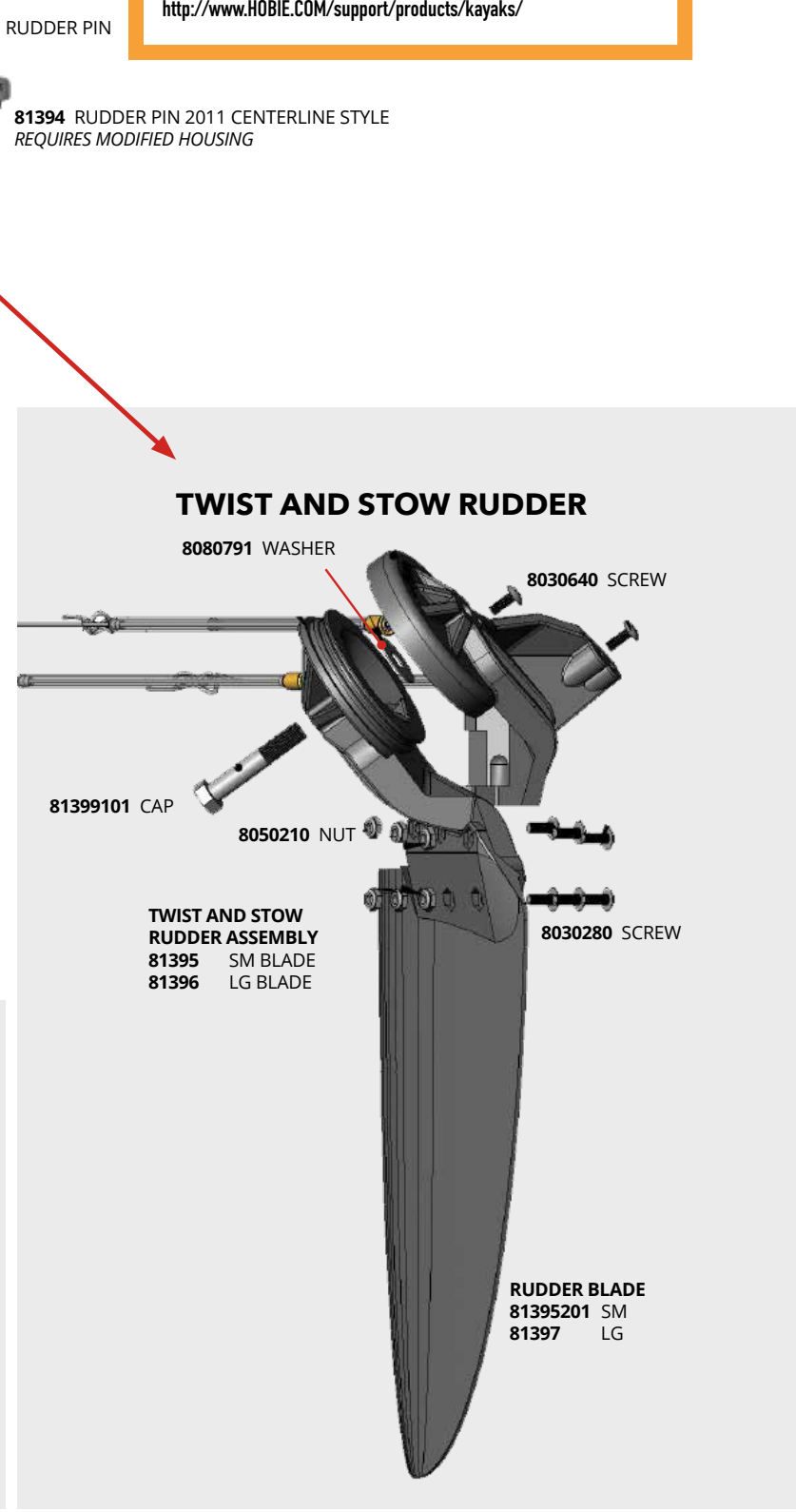

TWIST AND STOW RUDDER

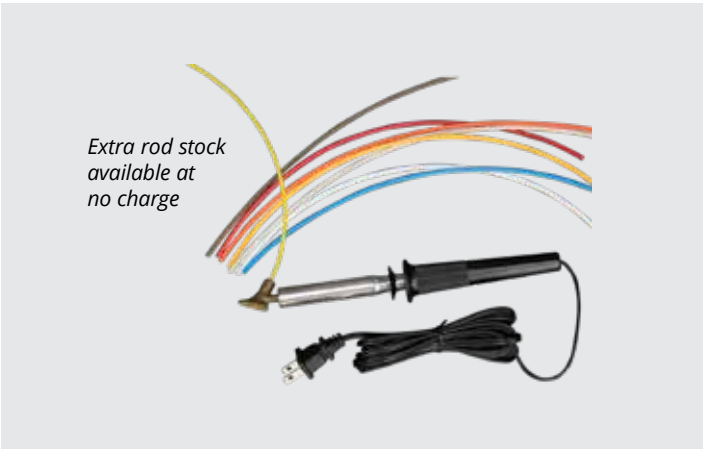

KC Welder Pro

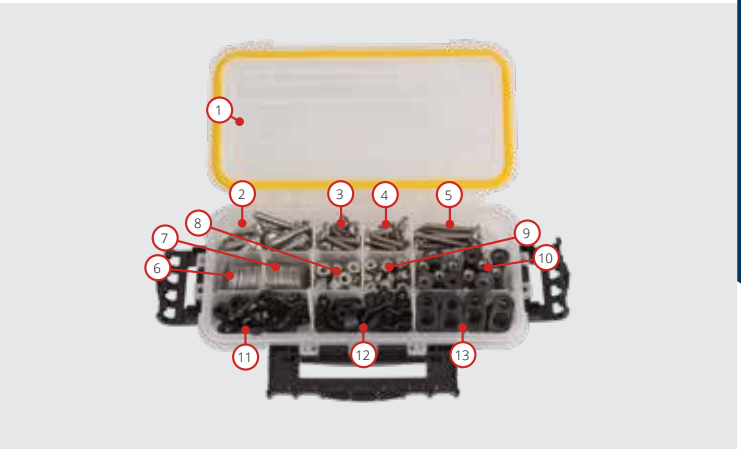

Kayak Rigging Kit - Hardware



Fish Grip



Hobie Pet PFDs



Hobie Boomerang Snips

TECH TIP

"WELL NUT" FASTENERS are tubular rubber fittings with an imbedded brass nut in the base. These are similar to a molly screw commonly used in sheet rock. They expand within the structure and give you a virtual backing nut and washer in an area that is inaccessible. Well nuts can be used for mounting many accessories to kayaks. Simply drill a hole as a net-fit dimension for the well nut. Insert the nut and position the hardware to be fastened. Insert and thread in the screw. Tighten until very snug. The brass nut is drawn up against the inside surface of the kayak which expands the rubber to a dimension that is too large to pull through the hole.



SCAN TO GO TO
HOBIE PARTS LOOKUP



SCAN TO GO TO
HOBIE SUPPORT PAGES

- 615 BOOK, PENGUIN BOAT FLIPPERS
- 72020019 FISH GRIP
- 72020103 BOOMERANG SNIPS
- 72020300 KAYAK RIGGING KIT - HARDWARE
- 72097001 KC WELDER PRO WITH ROD STOCK
- S9000LG PET PFD LG MANGO 60-90#
- S9000MD PET PFD MD MANGO 24-60#
- S9000SM PET PFD SM MANGO 12-24#
- S9000XL PET PFD XL MANGO >90#
- S9000XS PET PFD XS MANGO <12#

HOBIE

Global Headquarters
Oceanside, CA, U.S.A.

HOBIE AUSTRALASIA

Huskisson, NSW, Australia

HOBIE EUROPE

Toulon, France

HOBIE KAYAK EUROPE

Stellendam, The Netherlands

HOBIE BRASIL

Porto Belo, Santa Catarina, Brasil

www.hobie.com



KAYAKING AND ECLIPSE GEAR

INTERNATIONAL 87367261